



Americom Communications Corporation
P.O. Box 84546
Lincoln, NE 68501
Phone: (402) 489-9700
Fax: (402) 489-9771

Prepared especially for
Arlington Public Schools

On Wednesday, January 13, 2016

Prepared by Trevor M. Kinnett

Trevor@americom.biz

(877) 489-9700 x 212

Proposal: 17810
Created: 12/16/2015
Printed: 1/13/2016

Quantity Description

- 3 ACC Mag Lock, 1200 lbs.
- 2 ACC Request to exit button faceplate
- Miscellaneous materials & conduit

Access Control Labor

Your Price:
\$2,350.00

Total:
\$2,350.00

Prices are firm until 1/15/2016 Terms: Due on Receipt

Quoted by: Trevor M. Kinnett, Trevor@americom.biz

Date: 12/16/2015

SCOPE OF WORK:

Americom proposes to install [3] new single door maglocks and remove [3] double door maglocks as well as remove [2] motion detectors and install [2] new motion detectors on existing doors.

INCLUDED:

- Install new single door maglock on existing door on west side of weight room (remove double mag, customer will permanently lock second door)
- Install new single door maglock on existing door on southeast side of gym (remove double mag, customer will permanently lock second door)
- Install new single door maglock on existing door on southwest side of gym (remove double mag, customer will permanently lock second door)
- Remove motion detector on south entrance to HS and install push to exit button
- Remove motion detector on main entrance doors and install push to exit button
- Installation labor

NOT INCLUDED:

- Any access control headend equipment
- Door hardware
- Cabling

Accepted by: _____

Date: _____

The customer is responsible for any and all sales and/or use tax that may be due for this order. A down payment of 50% of the total with sales tax is due upon signing this contract. The balance is due upon completion. All equipment is considered the property of Americom until payment has been received in full.

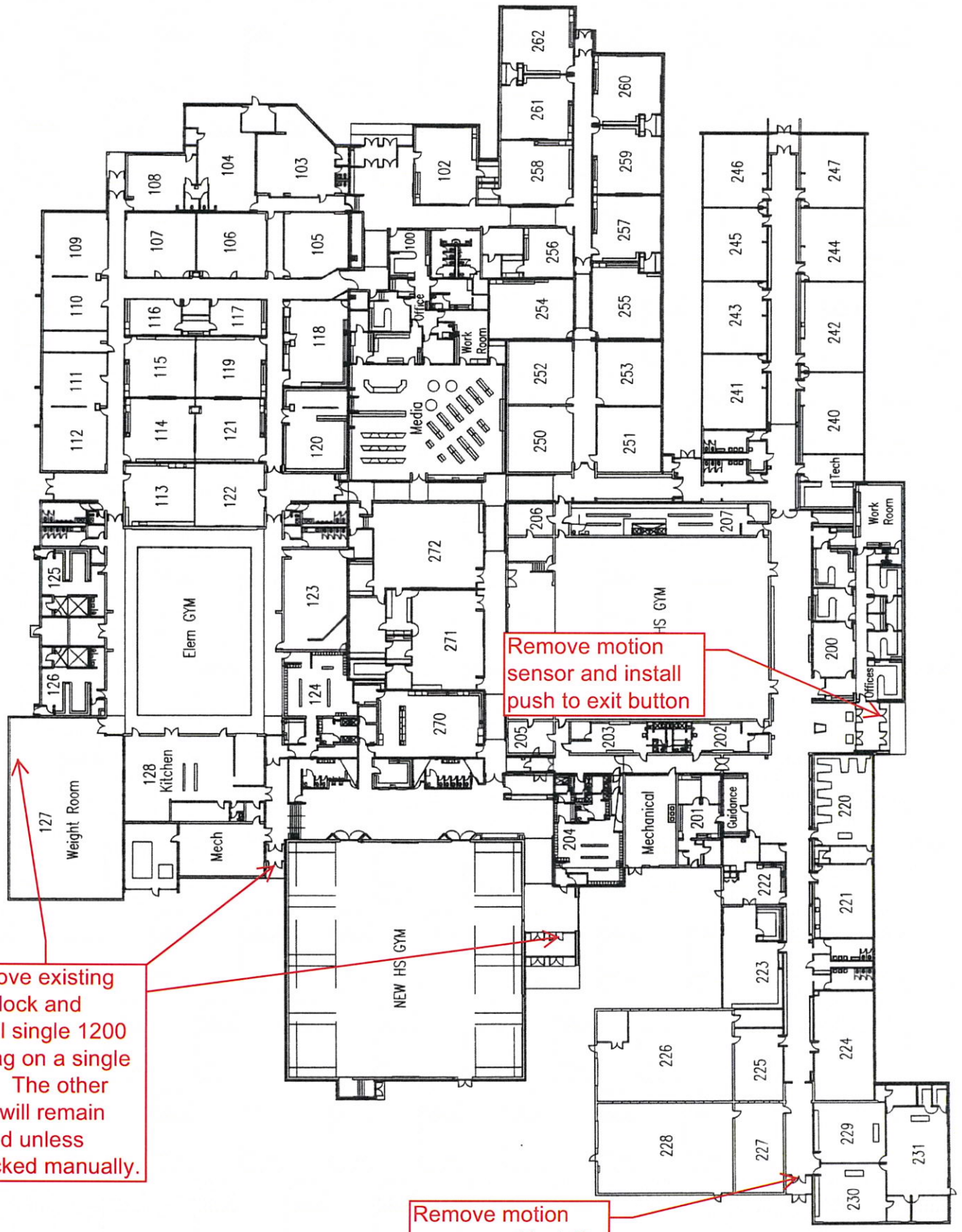

Remove existing mag lock and install single 1200 lb mag on a single door. The other door will remain locked unless unlocked manually.

Remove motion sensor and install push to exit button

Remove motion sensor and install push to exit button