



Academy of Medical Sciences Project
CCC Board of Governors Meeting February 18, 2021



Grand Island Public Schools Academy of Medical Sciences

The Problem



Not having enough staff to care for our sick and injured patients, that's what keeps me up at night. I hear it from my fellow hospital administrators across the state.

Ed Hannon, President CHI-Health St. Francis



Grand Island Public Schools Academy of Medical Sciences

The Problem

In 2020, Grand Island's population shifted to be home to more residents 75 years old and older, than children five years old and younger. This shift affects all segments of the Grand Island community – business, housing education, and healthcare.



Dave Taylor

President Grand Island Economic Development Corporation

Grand Island MSA:

84,000

Population of Grand Island:

51,478

Median value of owner occupied housing units:

\$130,200

Median household income:

\$51,627

Per capita income (2017):

\$25,411

Persons in poverty:

15%

Unemployment Rate:

June 2019 3.4%



Grand Island Public Schools Academy of Medical Sciences

Project Scope

The Grand Island Senior High Academy of Medical Sciences will re-locate to a 'school within a hospital' at a renovated 8th floor of CHI-Health St. Francis Hospital. The project including construction and programming will cost **\$7,273,136**.

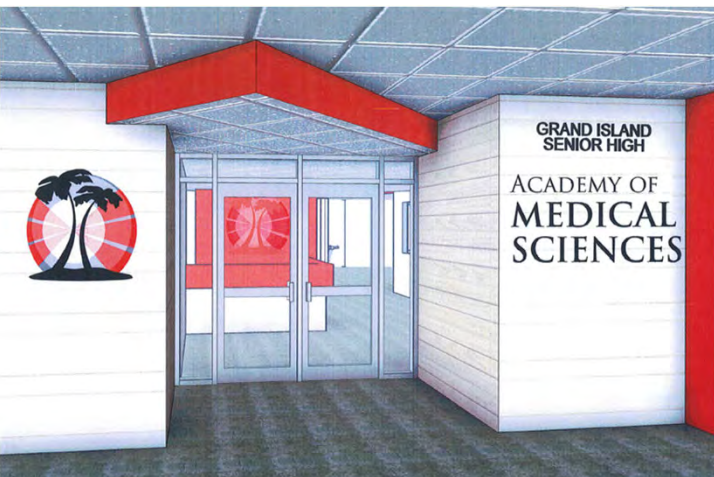

The project will address the following:

- Need for Healthcare and Emergency Services Workers in the Region
- Support growth and diversification of Grand Island's economy
- Expose and involve 450 students annually to the Healthcare field
- Give students hands on, environment and industry specific experiences to further their instruction in healthcare



Grand Island Public Schools Academy of Medical Sciences

Partnership

Grand Island Public Schools



Central Community College



CHI Health St. Francis



Community





Grand Island Public Schools Academy of Medical Sciences **Project Partner**

Academy Model Experience



2013 – Grand Island Public Schools opened the Career Pathways Institute (CPI), revolutionizing experiential learning for students in six pathways. All six programs partnered with local businesses and Central Community College to offer industry certifications, dual credit, and work-based learning opportunities.

These programs were open to **all students in Hall County**, and about 15% of the students that attended CPI annually were from non-GIPS high schools.

Fall 2020 – 395 Grand Island Public School students (duplicate headcount) enrolled in 29 CCC early college courses equating to 1,093 credit hours or 36.43 FTE.



ACADEMY OF
**MEDICAL
SCIENCES**SM
MY CHOICE, OUR VOICE.



Grand Island Public Schools Academy of Medical Sciences

Project Partner

Academy of Medical Sciences Pathways



Emergency Services

Health Care

Sports Medicine/Therapy

Biomedical Sciences



Grand Island Public Schools Academy of Medical Sciences

Project Partner

Academy Model

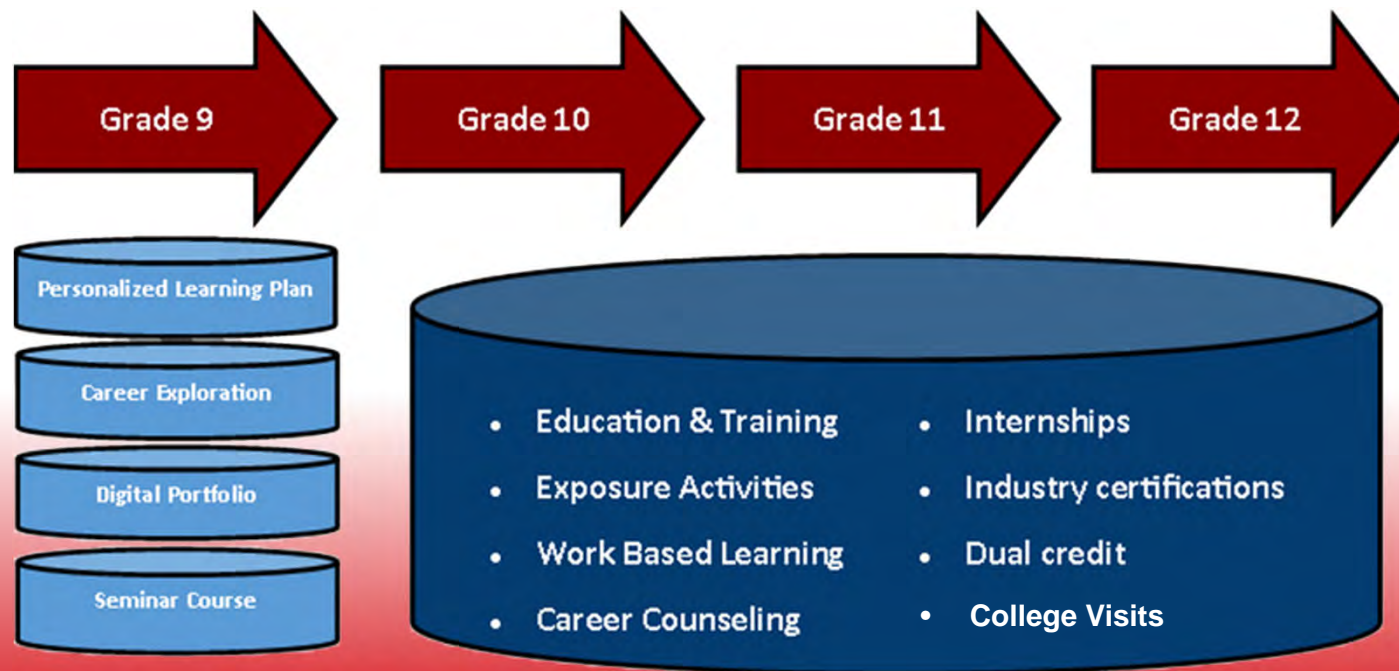



Grand Island Public Schools Academy of Medical Sciences

Project Partner

Grand Island Senior High Total Demographics



2559 Students

56% Hispanic

12% English learner

36% White

69% Free/reduced

3.5% Other

18% Special education

4.5% Black or African
American

46% Female



Grand Island Public Schools Academy of Medical Sciences

Project Partner

Academy of Medical Sciences Demographics



415 Students

52% Hispanic

10% English learner

37% White

66% Free/reduced

3% Two or more races

11% Special education

1% Asian

69% Female

7% Black or African
American



Grand Island Public Schools Academy of Medical Sciences

Project Partner

2019-2020 Highlights

88 Academy students completed a pathway

122 Total pathways completed by those students

104 Students earned their CNA

10 Students earned their EMR

24 Students participated in January CNA Hiring Fair with **6** business partners represented





Grand Island Public Schools

Project Partner

Academy of Medical Sciences Advisory Committee Members

Medical Partners

Beth Bartlett, CHI Health St. Francis

Larry Speicher, GI Regional

Matt Hilligas, LiveWell Physical Therapy

Angie Jones, GI Physical Therapy

Jeremiah Johnson, Athletico Physical Therapy

Cody Raile, FeelFit

Russ Blackburn, GI Fire, City of Grand Island

Jon Roselund, City of Grand Island

Educational Partners

Dr. Marcie Kemnitz, CCC

Dr. Scott Unruh, UNK

Peggy Abels, UNK

Lisa Albers, GIPS Board of Education



Pathway	Courses	Dual Credit Options	Industry Certifications	Postsecondary Degree Options			Potential Careers
				Associate's	Bachelor's	Advanced	
College and Career Readiness 							
HEALTHCARE	Grade 10: Foundations of Medical Sciences Grade 11: "Principles" course in declared pathway Grade 12: "Advanced" course in declared pathway	<ul style="list-style-type: none">HLTH 1200 - Nursing AssistantHLTH1210- Medication Aide	<ul style="list-style-type: none">Certified Nursing AssistantCPRBasic Life Support	<ul style="list-style-type: none">Registered NurseDental HygienistDental AssistingMedical AssistingMedical Lab Tech	<ul style="list-style-type: none">Science in NursingBiochemistry / ChemistryPre-DentalPre-MedicinePre-Pharmacy	<ul style="list-style-type: none">Medical DoctorDoctor of PharmacyDoctor of DentistryDoctor of Chiropractic	<i>Registered Nurse, Nurse Practitioner, Radiologic Technologist, Medical and Clinical Lab Technician, Physician, Surgeon, Pharmacist, Family and General Practitioner, Optometrist, Dental Hygienist, Medical Records/Health Information.</i>
EMERGENCY SERVICES		<ul style="list-style-type: none">HLTH 1780- Emergency Medical ResponderHLTH 1870- Emergency Medical Technician	<ul style="list-style-type: none">CPRBasic Life SupportEMREMT	<ul style="list-style-type: none">ParamedicineFire ScienceRegistered NurseEMT	<ul style="list-style-type: none">Science in NursingBiologyChemistry	<ul style="list-style-type: none">Masters of Science in Emergency Management	<i>Emergency Medical Technician, Paramedic, Firefighter, Disaster Program, Specialist, Military, Critical Care, Transport</i>
SPORTS MEDICINE / THERAPY		<ul style="list-style-type: none">PE264- Foundations of Athletic TrainingREC304- Volunteer Practicum in Athletic Training Foundations	<ul style="list-style-type: none">CPRBasic Life Support	<ul style="list-style-type: none">Occupational Therapy AssistantPhysical Therapy Assistant	<ul style="list-style-type: none">Exercise ScienceKinesiologyPre-Physical TherapyAthletic TrainingGerontology	<ul style="list-style-type: none">Occupational TherapyPhysical TherapyBiomedical Engineering	<i>Physical Therapist, Occupational Therapist, Chiropractor, Occupational Therapy Assistant, Dietitian, Nutritionist</i>
BIO/MEDICAL SCIENCES		<ul style="list-style-type: none">TBD	<ul style="list-style-type: none">CPRBasic Life Support	<ul style="list-style-type: none">Registered NurseDental HygienistDental AssistingMedical AssistingMedical Lab Tech	<ul style="list-style-type: none">Science in NursingBiochemistry / ChemistryPre-DentalPre-MedicinePre-Pharmacy	<ul style="list-style-type: none">Medical DoctorDoctor of PharmacyDoctor of DentistryDoctor of Chiropractic	<i>Registered Nurse, Nurse Practitioner, Radiologic Technologist, Medical and Clinical Lab Technician, Physician, Surgeon, Pharmacist, Family and General Practitioner, Optometrist, Dental Hygienist, Medical Records/Health Information.</i>



Central Community College **Project Partner**

Student Opportunities:



Dual credit

Industry Certifications

- Certified Nursing Assistant
- Medication Aide
- EMR and EMT

Associates Degree Options

- Nursing
- Paramedicine
- Occupational Therapy Assistant
- Pharmacy Technician
- Medical Laboratory Technician
- Medical Assisting

Pathways to 4-year Institutions



Central Community College **Project Partner**

CCC Highlights

25 County Service Area – South Central Nebraska

94% Graduates stay in service area

9 Health Science Programs – leading to state or national certification

7 Health Science Programs offered on Grand Island Campus
including Nursing

Nursing Simulation Center – supports skill practice and mastery

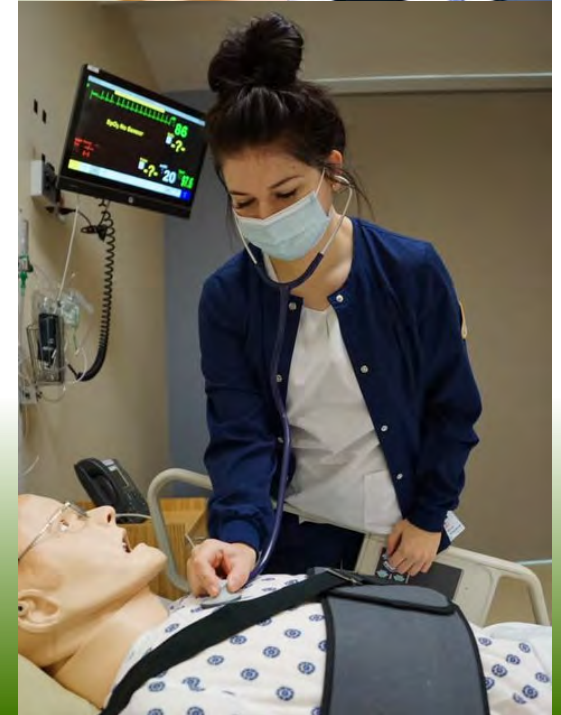



CHI Health St. Francis
Project Partner

Taking Education to the Next Level

More than 150 Students from Grand Island Senior High and Hall County Schools will attend the 'School within a Hospital' per day

- A/B block schedule
- Seniors on A day
- Juniors on B day

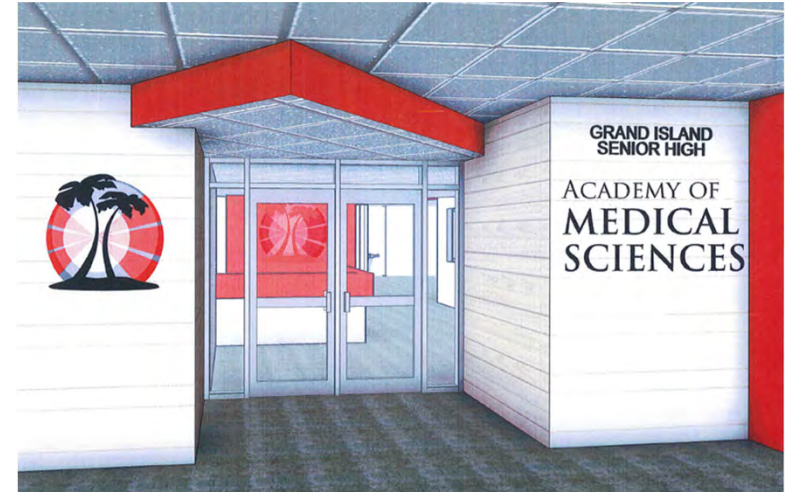



CHI Health St. Francis Project Partner

Health Care Simulator Lab

Features:

- 6 patient-care room simulations
- Apollo – high fidelity sim unit
- Lab seating 24 students

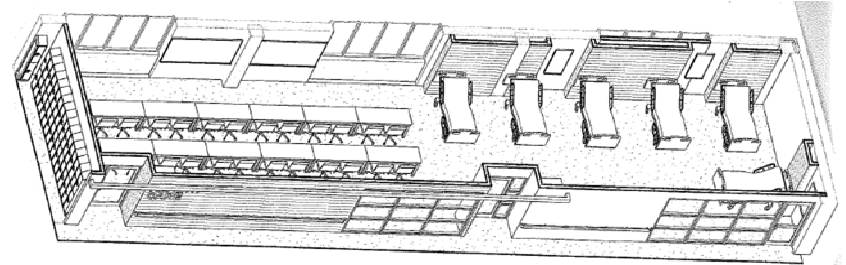



CHI Health St. Francis **Project Partner**

Emergency Services Simulator Lab

Features:

- 2 full-motion ambulance simulators
- Medium fidelity mannequins
- Classroom seating 24 students





CHI Health St. Francis

Project Partner

Sports Medicine/PT Lab and Bio Medical Lab

Features:

- 6 adjustable training/taping tables
- Classroom seating 24 students
- Ares – medium fidelity mannequins
- Flexible work spaces to allow project curriculum to be delivered
- Storage space

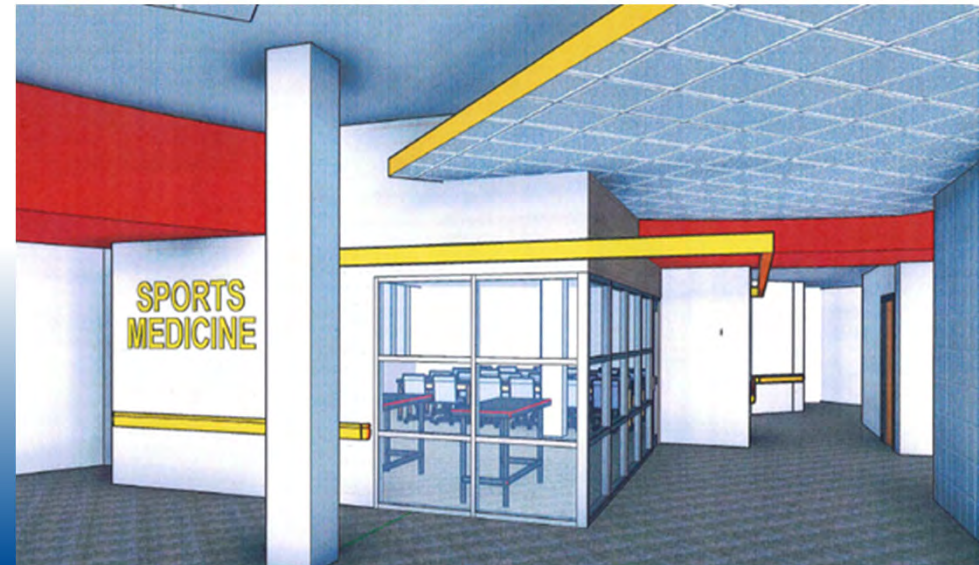



CHI Health St. Francis **Project Partner**

4 Classrooms/Labs

Features:

- Physiology Science Lab
- Anatomy & Physiology Science Lab
- General Education Classroom 1
- General Education Classroom 2

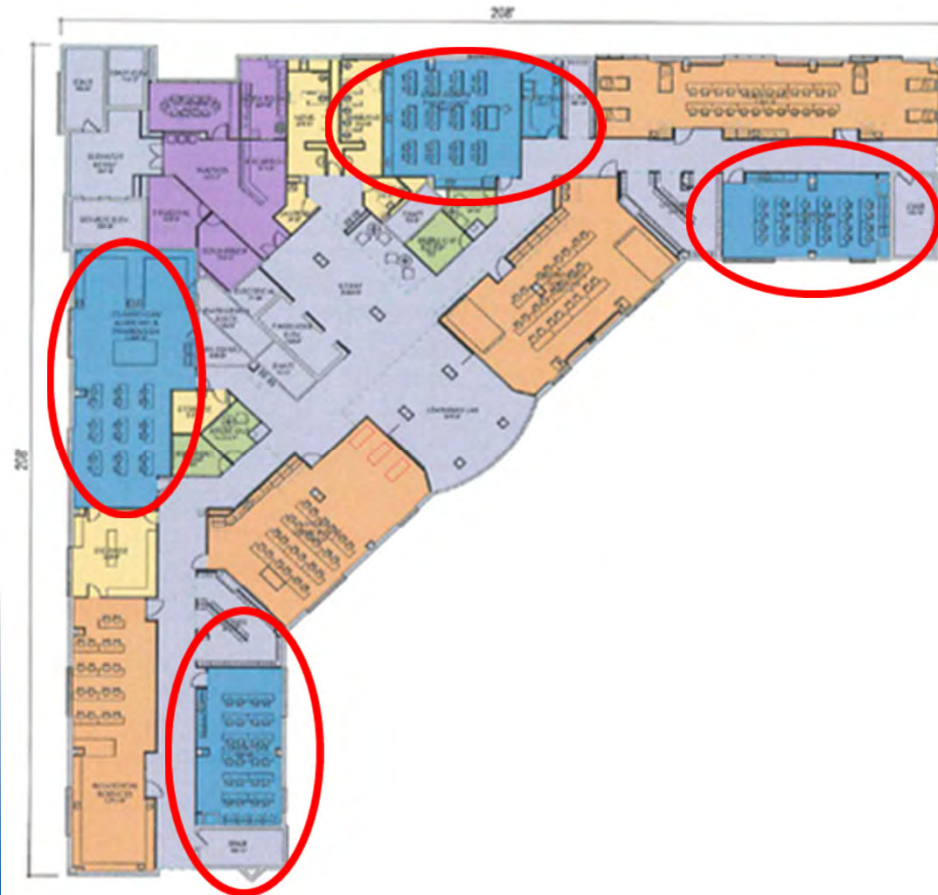



Grand Island Public Schools Academy of Medical Sciences

Project Budget

Total Project Cost: \$7,273,136

Construction: \$5,625,000
 Startup: \$70,400
 Equipment/Furnishings: \$437,000
 Sub-Total \$6,132,000

In-Kind:
 Annual Program Costs: \$1,140,736
 In-kind Startup: \$55,000
 In-kind Equipment: \$131,000

Total Construction (less In-kind): \$5,946,000

Line Item	Construction & Startup	Annual Academy Costs	Total Provided In-kind
PERSONNEL			
Construction Supervisor	\$30,000	\$0	\$30,000
Academy Coordinator	\$25,000	\$0	\$25,000
Pathway Teachers	\$0	\$480,000	\$480,000
Academy Administrator	\$0	\$50,000	\$50,000
Academy Counselor	\$0	\$35,000	\$35,000
Fringe Benefits (28% of salaries)	\$15,400	\$158,200	\$173,600
SUBTOTAL	\$70,400	\$723,200	\$793,000
SUPPLIES			
Academy Supplies, Equipment & Furnishings	\$437,000	\$0	\$131,000
SUBTOTAL	\$437,000	\$0	\$131,000
CONSTRUCTION			
Base construction/renovation	\$4,542,805	\$0	\$0
IT Infrastructure	\$80,000	\$0	\$0
Temperature Controls	\$65,000	\$0	\$0
Testing	\$25,000	\$0	\$0
Printing	\$25,000	\$0	\$0
Air Balancing	\$40,000	\$0	\$0
Contingency	\$474,534	\$0	\$0
Architectural and MEP Fees	\$372,661	\$0	\$0
SUBTOTAL	\$5,625,000	\$0	\$0
OTHER			
Dual Credit Tuition	\$0	\$100,000	\$100,000
SUBTOTAL	\$0	\$100,000	\$100,000
LEASED SPACE			
Space valued at a modest \$16/sq ft.	\$0	\$317,536	\$317,536
SUBTOTAL	\$0	\$317,536	\$317,536
TOTAL PROJECT COSTS	\$6,132,400	\$1,140,736	\$1,326,736



Project Timeline



Today's students are tomorrow's workers. When educators and employers team up to address workforce challenges, everyone benefits – students, families, employers, and the community.

Dr. Tawana Grover
Superintendent Grand Island Public Schools

