

Final Plat  
PINE RIDGE 3RD ADDITION  
Lots 4, 5, 6, and 7 of Pine Ridge 2nd Addition,  
City of Crete, Saline County, Nebraska

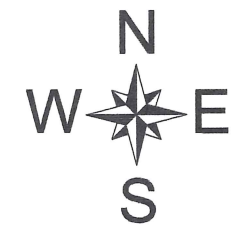

Drawn By: AMP  
Date: June 4, 2024  
Project Number: S-076-003  
Scale: 1"=60'

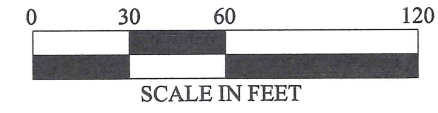

LEGEND

- Property Corner Found
- Property Corner Set (5/8" x 24" I.B. w/Cap)
- M Measured Distance
- R Recorded Distance (LJS) Leslie J. Siedschlag, LS #469, dated September 2, 1997. (TLS) Terry L. Schulz, LS #550, dated May 1, 2018.

Situation Sketch  
R-4-E

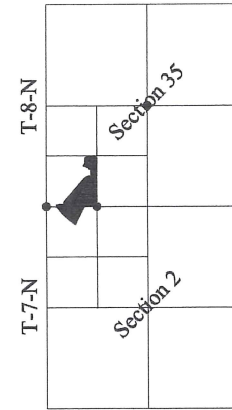

Saline County, Nebraska

Curve Data

A	58.60' Arc Length	B	49.93' Arc Length
	45.00' Radius		45.00' Radius
	54.55' Chord Length		47.41' Chord Length
	N 53°45'21" W		S 57°08'58" W
C	47.40' Arc Length	D	61.14' Arc Length
	45.00' Radius		45.00' Radius
	45.24' Chord Length		56.54' Chord Length
	S 04°38'36" E		N 73°54'17" E

LEGAL DESCRIPTION

Lots 4, 5, 6, and 7 of Pine Ridge 2nd Addition, Section 2, T7N, R4E of the 6th P.M., Saline County, Nebraska

SURVEYOR'S CERTIFICATE

I, Terry L. Schulz, Nebraska Registered Land Surveyor No. 550, duly registered under the Land Surveyor's Regulation Act, do hereby state that I have performed a survey of the land depicted on the accompanying plat; that said plat is a true delineation of said survey performed personally or under my direct supervision; that said survey was made with reference to known and recorded monuments marked as shown, and to the best of my knowledge and belief is true, correct and in accordance with the Land Surveyor's Regulation Act in effect at the time of this survey.

Terry L. Schulz  
Terry L. Schulz, State of Nebraska, LS #550

6-13-2024  
Date

DEDICATION

Know all persons by these presents: that I, Tony Fitzgerald, Manager of Pine Ridge, LLC, a Limited Liability Company, owner of the land described and embraced within this plat have caused said land to be subdivided into lots and streets, to be numbered as shown, said subdivision to be hereafter known as PINE RIDGE 3rd ADDITION, and I do hereby dedicate the easements shown thereon for the location, construction, reconstruction, replacement, repair, operation and maintenance of public service utilities, over, upon or under the easements as shown on the foregoing plat. The construction or location of any buildings or trees shall be prohibited in said easements, but the same may be used for gardens, shrubs, landscaping and other purposed that do not then or later interfere with the aforesaid uses or rights herein granted.

Witness my hand this \_\_\_\_\_ day of \_\_\_\_\_, 2024.

\_\_\_\_\_  
Tony Fitzgerald, Manager  
Pine Ridge, LLC

ACKNOWLEDGEMENT OF NOTARY

STATE OF NEBRASKA )  
SALINE COUNTY ) SS

On this \_\_\_\_\_ day of \_\_\_\_\_, 2024, before me the undersigned, a notary public duly commissioned in and for said county and state, personally came Tony Fitzgerald, Manager of Pine Ridge, LLC, a Limited Liability Company whose name is affixed to the dedication of this plat and she did acknowledge the execution to be her own voluntary act deed.

My commission expires on the \_\_\_\_\_ day of \_\_\_\_\_, 2024.

\_\_\_\_\_  
Notary Public

APPROVAL OF CRETE CITY COUNCIL

This plat of PINE RIDGE 3RD ADDITION was approved by the Crete City Council on this \_\_\_\_\_ day of \_\_\_\_\_, 2024.

ATTEST

City Clerk \_\_\_\_\_ Mayor \_\_\_\_\_

APPROVAL OF CRETE CITY PLANNING BOARD

This plat of PINE RIDGE 3RD ADDITION was approved by the Crete City Planning Board on this \_\_\_\_\_ day of \_\_\_\_\_, 2024.

ATTEST

\_\_\_\_\_  
Chairperson