

Windstream  
LOCATION MAP  
E 4TH ST

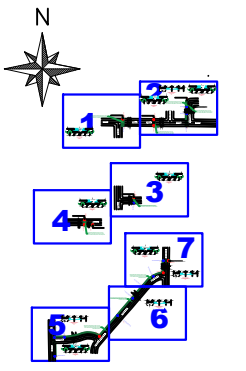

LEGEND

	PROPOSED CONDUIT
	AERIAL OVERLASH
	SW
	BOC
	EOP
	POLE
	POWER POLE

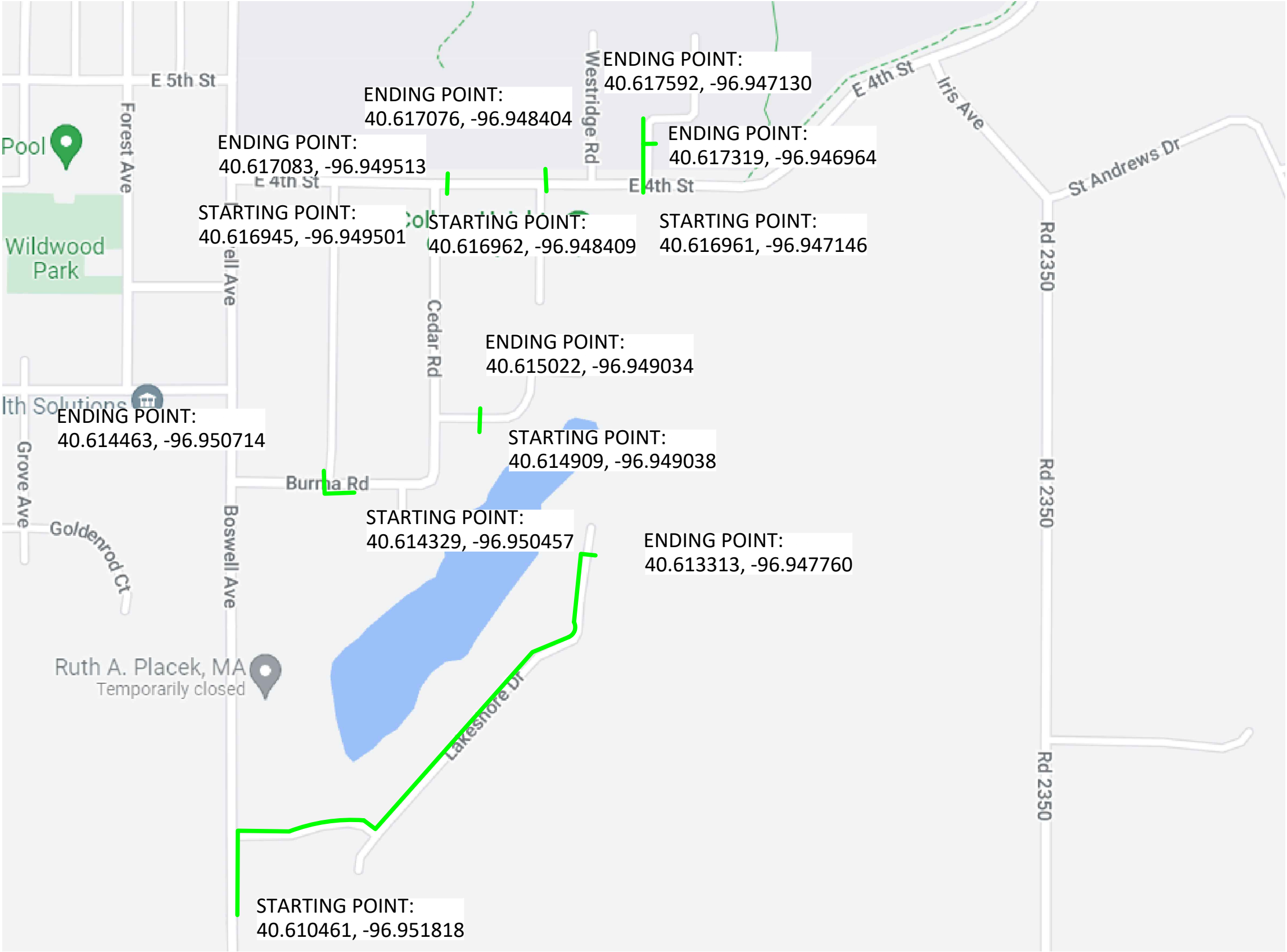

DATE CREATED:	7/14/22
DATE REVISED:	
DRAWN BY:	RAMTeCH

North arrow pointing up.

SCALE: NTS

COMPANY:	Windstream
SYSTEM:	ASHLAND, NE
PROJECT NUMBER:	715022049
DESCRIPTION:	FTTP GPON PERMIT
MAP:	

LOCATION MAP

RAMTeCH

# CITY PERMIT E 4TH ST

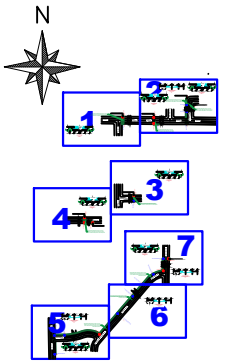
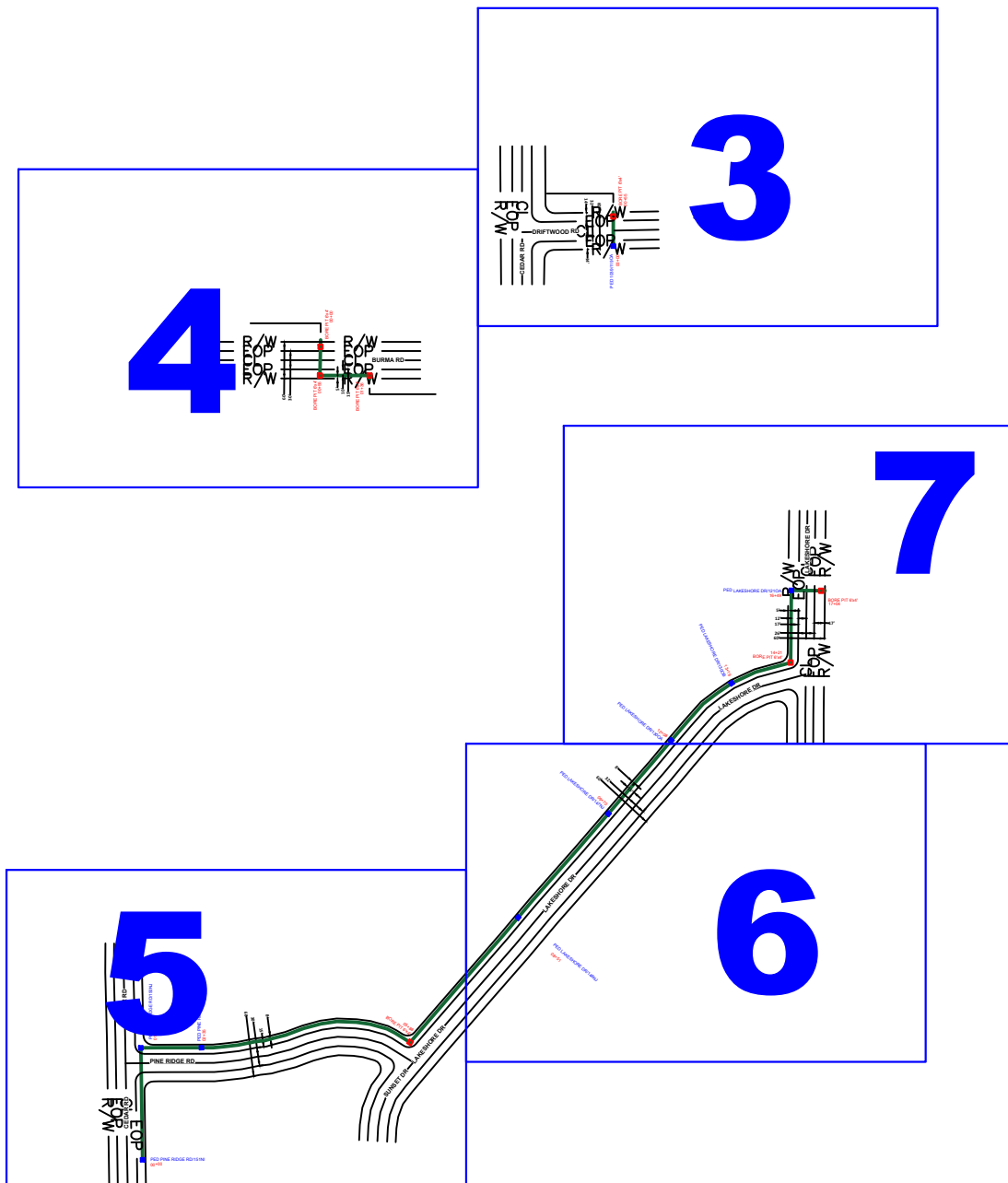
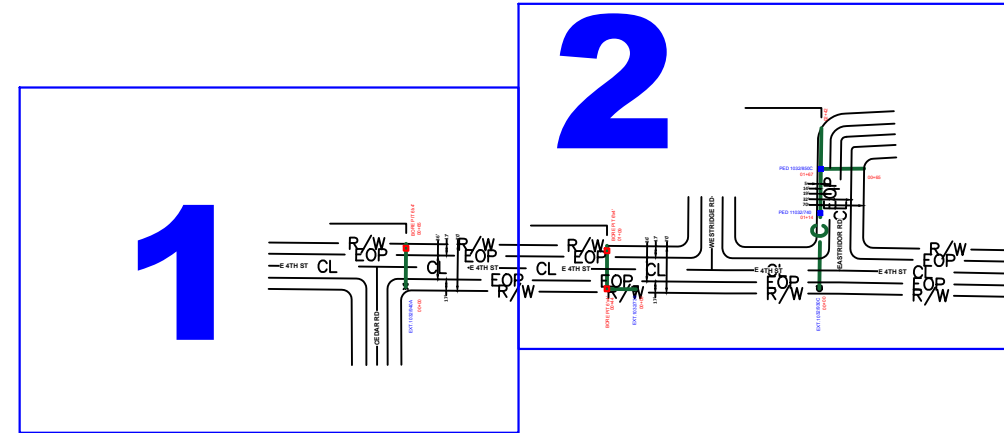

### LEGEND

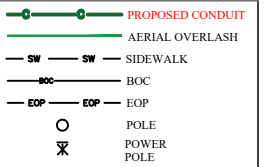

DATE CREATED: 7/14/22

DATE REVISED:

DRAWN BY: RAMTeCH

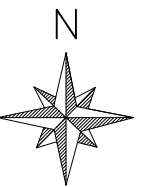

SCALE: NTS

COMPANY:

Windstream

SYSTEM:  
ASHLAND, NE

PROJECT NUMBER:  
715022049

DESCRIPTION:  
FTTP GPON PERMIT

---

MAP:

## KEY MAP

RAMTeCH

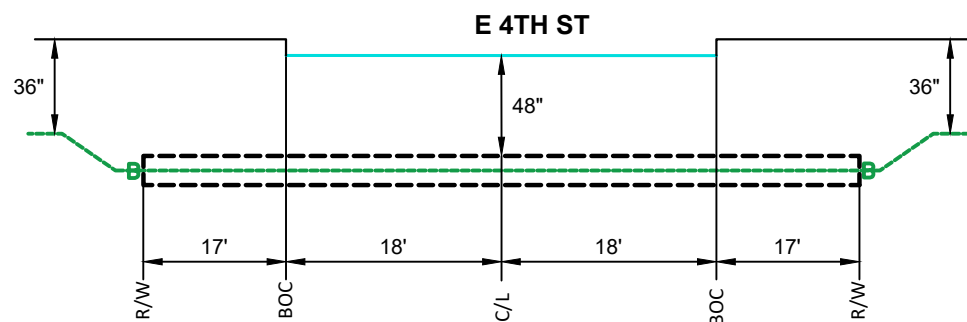

TYPICAL BORE DETAIL  
2 LANE ROAD CROSSING  
LOOKING EAST  
NTS

DIRECTIONAL BORE AND PLACE 65' OF 1(1.25)"  
INNERDUCT WITH 48CT FIBER CABLE AT A DEPTH  
OF 48" FROM POLE 1032/940A TO PED 1037/860A.

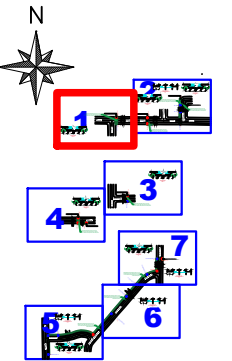
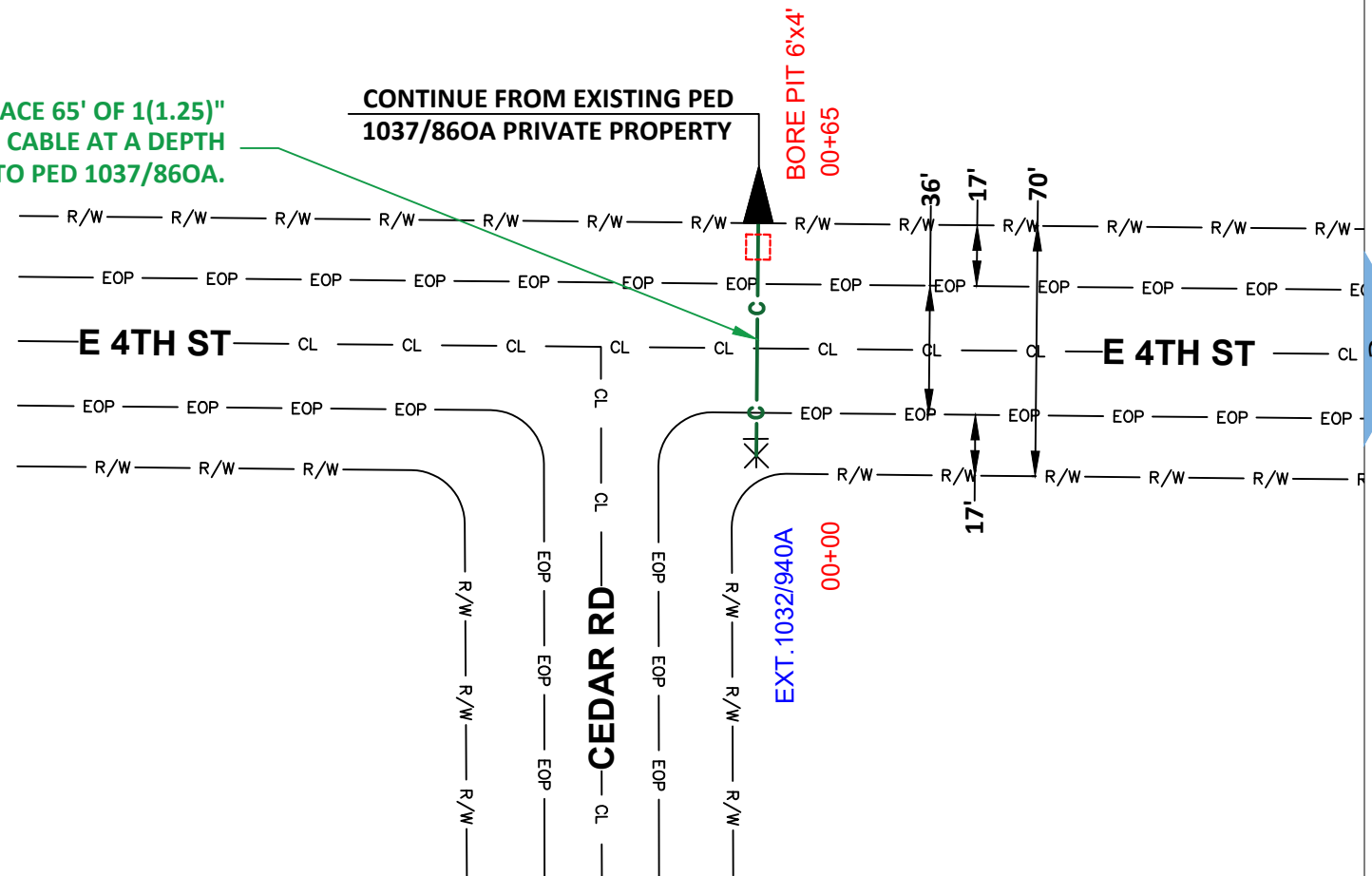

LEGEND

- PROPOSED CONDUIT
- AERIAL OVERLASH
- SIDWALK
- BOC
- EOP
- POLE
- POWER POLE



DATE CREATED: 7/14/22

DATE REVISED:

DRAWN BY: RAMTeCH



SCALE: 1:50

COMPANY:

Windstream

SYSTEM:

ASHLAND, NE

PROJECT NUMBER:

715022049

DESCRIPTION:

FTTP GPON PERMIT

MAP:

1 OF 7

RAMTeCH

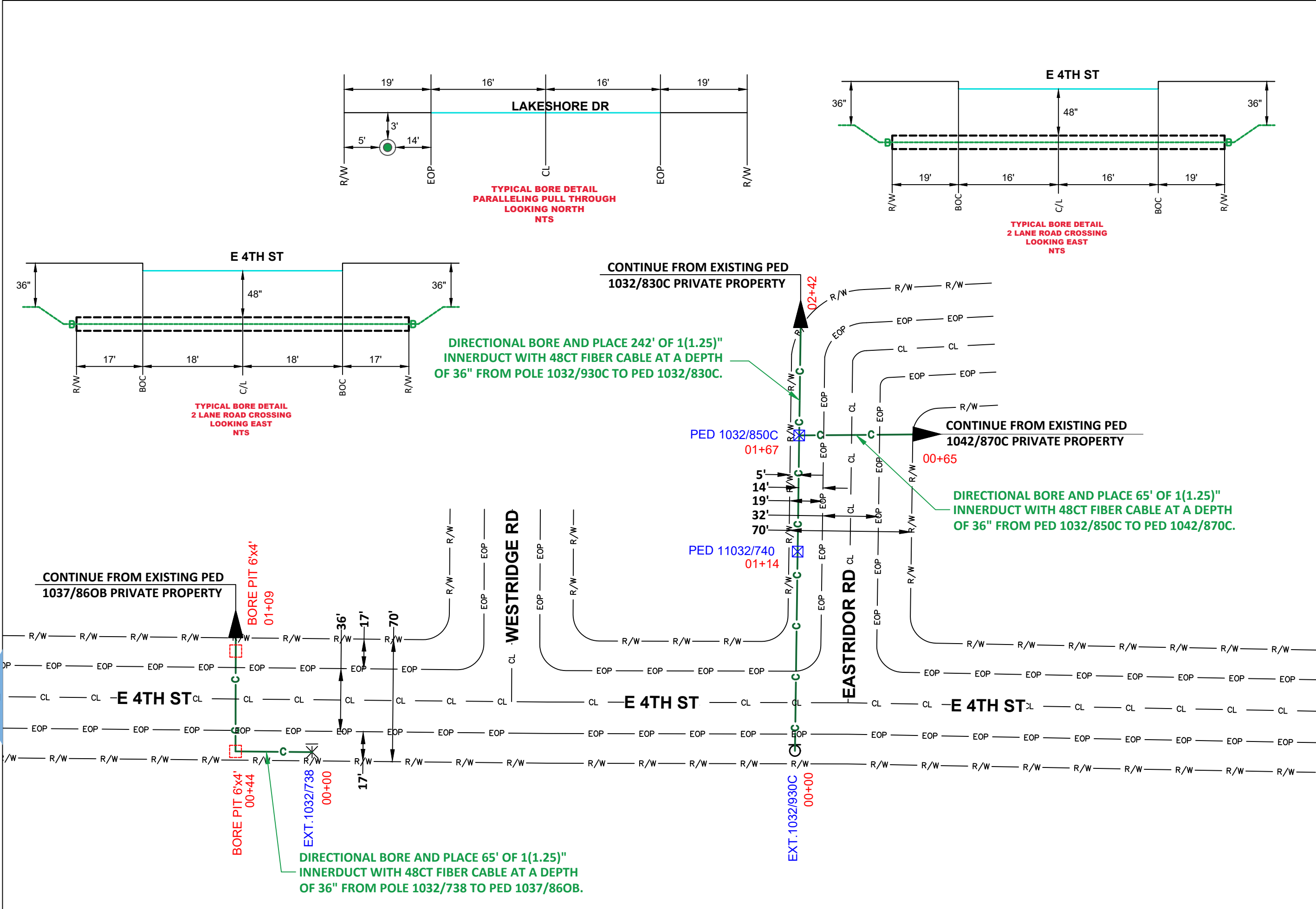

LEGEND

- PROPOSED CONDUIT
- AERIAL OVERLASH
- SW SIDEWALK
- BOC BOUNDARY OF CONDUIT
- EOP END OF PROJECT
- POLE
- POWER POLE

DATE CREATED: 7/14/22

DATE REVISED:

DRAWN BY: RAMTeCH

SCALE: 1:50

COMPANY:  
Windstream

SYSTEM:  
ASHLAND, NE

PROJECT NUMBER:  
715022049

DESCRIPTION:  
FTTP GPON PERMIT

MAP:

2 OF 7

RAMTeCH

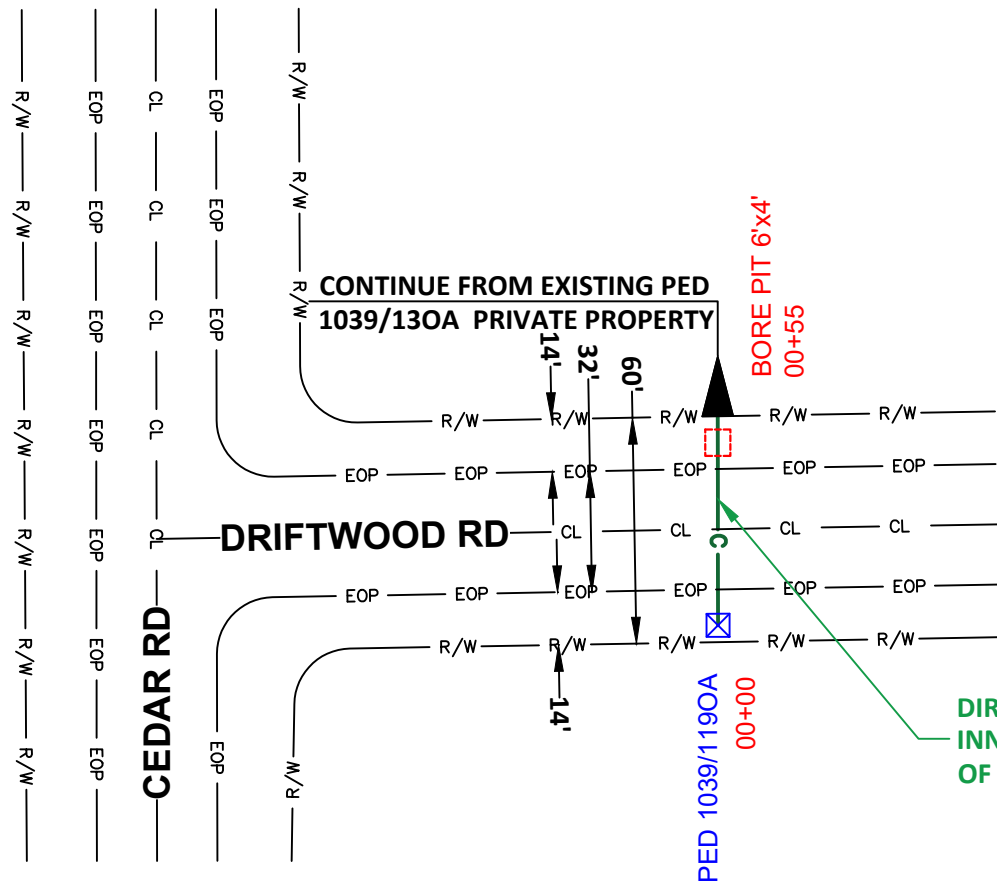

DIRECTIONAL BORE AND PLACE 55' OF 1(1.25)" INNERDUCT WITH 48CT FIBER CABLE AT A DEPTH OF 48" FROM PED 1039/1190A TO PED 1039/130A.

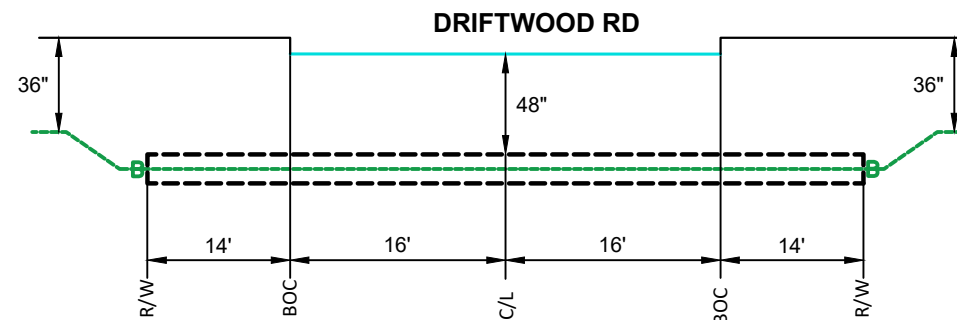

TYPICAL BORE DETAIL  
2 LANE ROAD CROSSING  
LOOKING EAST  
NTS

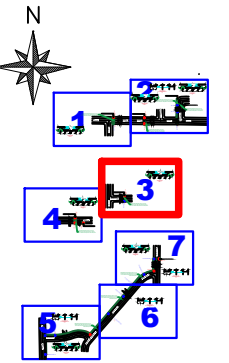

LEGEND

- PROPOSED CONDUIT
- AERIAL OVERLASH
- SW SIDEWALK
- BOC
- EOP
- POLE
- POWER POLE



DATE CREATED: 7/14/22

DATE REVISED:

DRAWN BY: RAMTeCH



SCALE: 1:50

COMPANY:  
Windstream

SYSTEM:  
ASHLAND, NE

PROJECT NUMBER:  
715022049

DESCRIPTION:  
FTTP GPON PERMIT

MAP:

3 OF 7

RAMTeCH

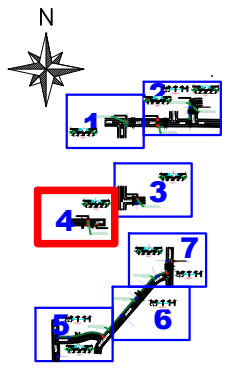
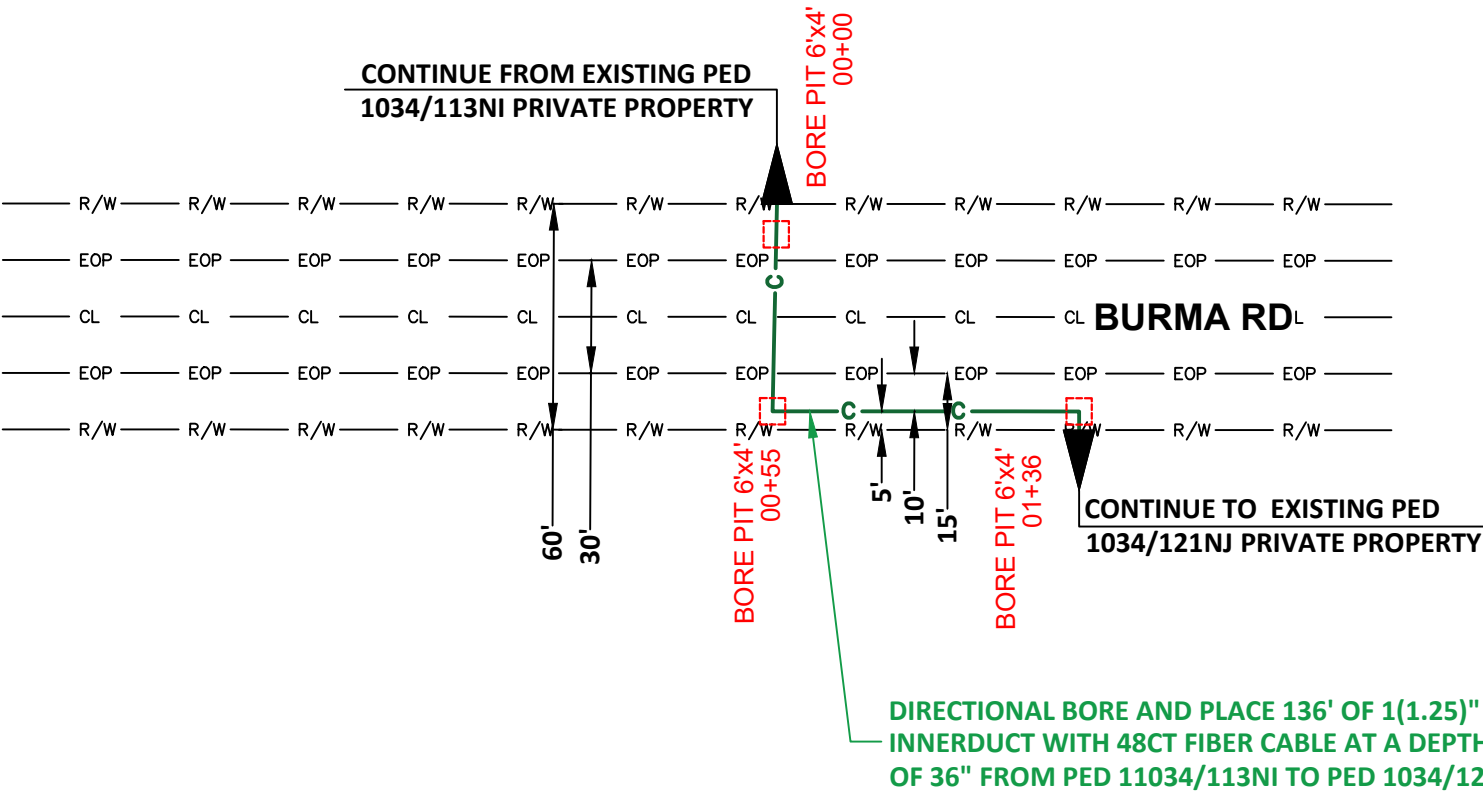
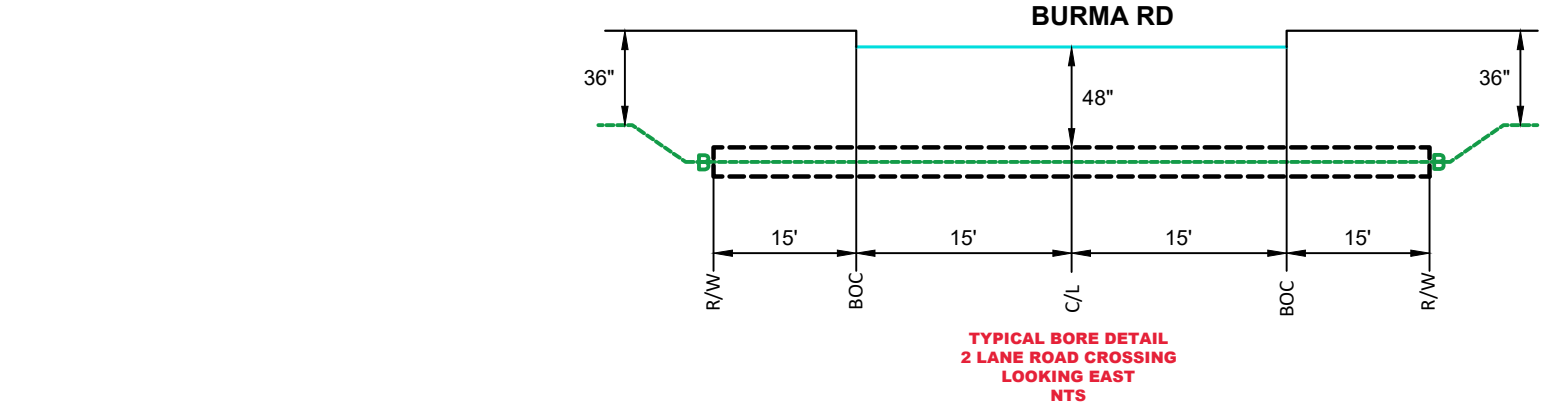

LEGEND

	PROPOSED CONDUIT
	AERIAL OVERLASH
	SW SIDEWALK
	BOC
	EOP
	POLE
	POWER POLE



DATE CREATED:	7/14/22
DATE REVISED:	
DRAWN BY:	RAMTeCH

N

SCALE: 1:50

COMPANY:	Windstream
SYSTEM:	ASHLAND, NE
PROJECT NUMBER:	715022049
DESCRIPTION:	FTTP GPON PERMIT
MAP:	

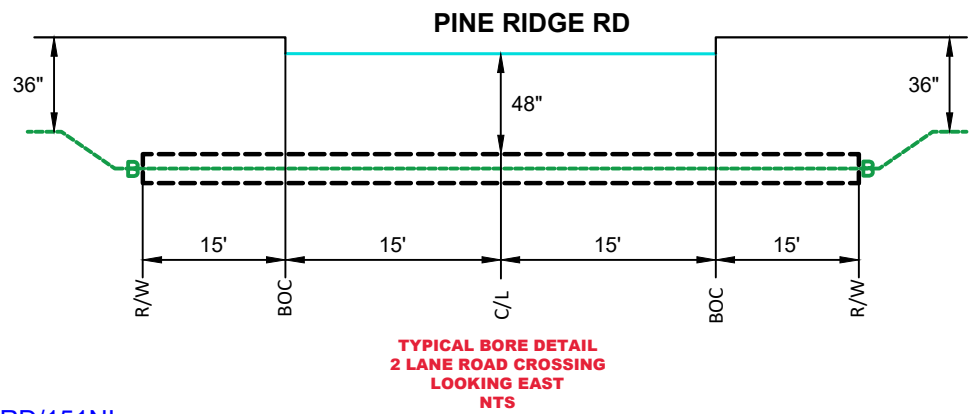
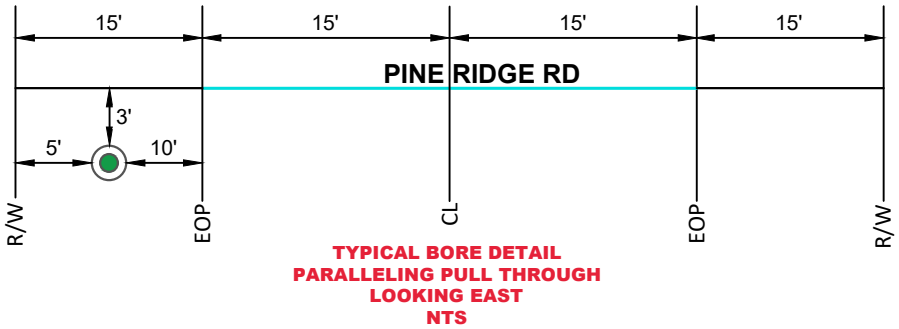
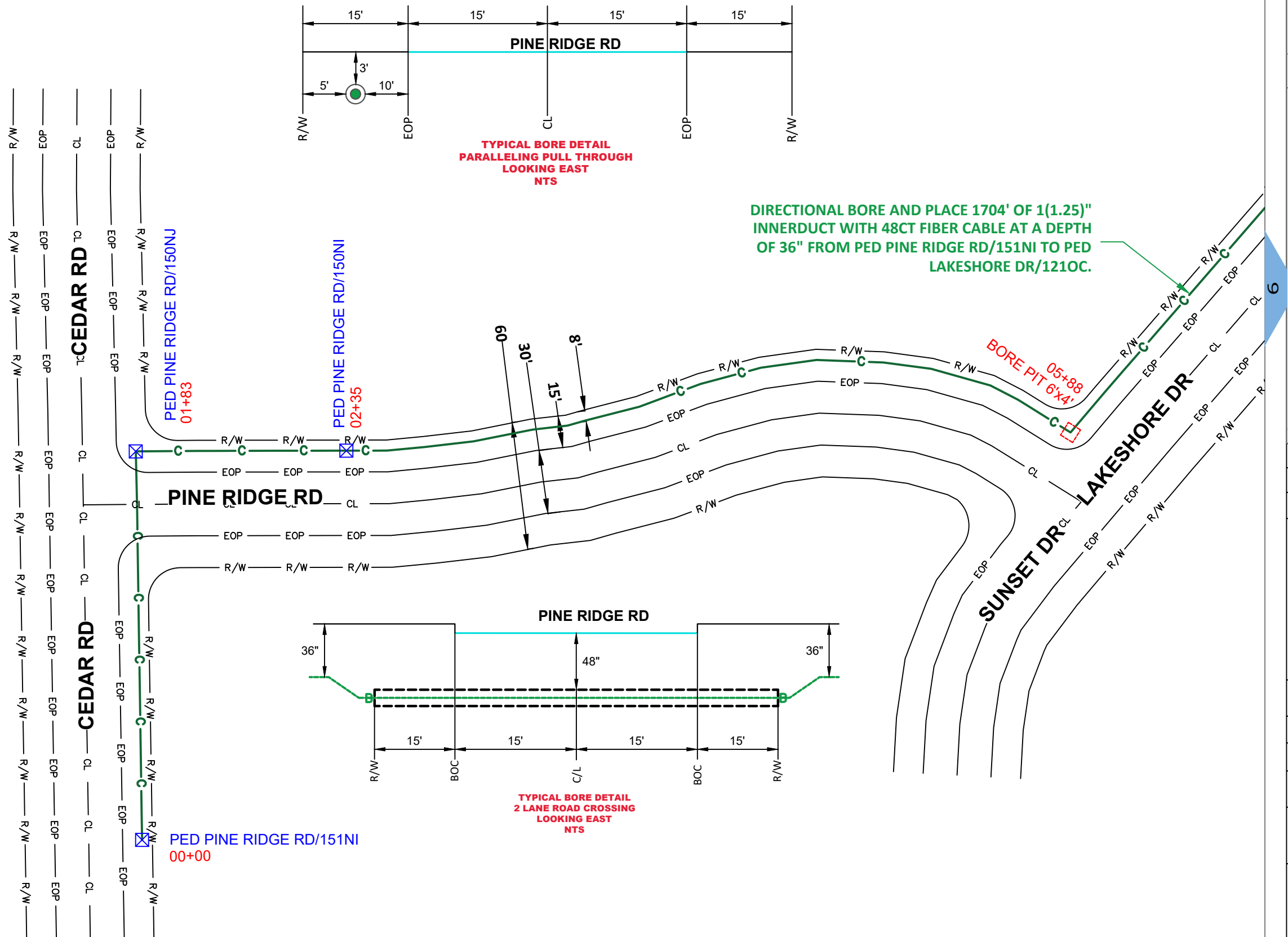

DIRECTIONAL BORE AND PLACE 1704' OF 1(1.25)"  
INNERDUCT WITH 48CT FIBER CABLE AT A DEPTH  
OF 36" FROM PED PINE RIDGE RD/151NI TO PED  
LAKESHORE DR/1210C.

BORE PIT 6'x4'  
05+88

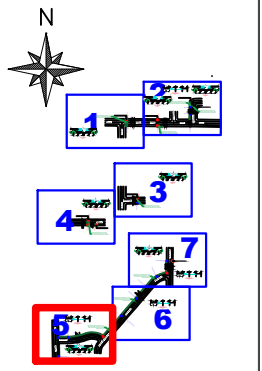

LEGEND	
	PROPOSED CONDUIT
	AERIAL OVERLASH
	SIDEWALK
	BOC
	EOP
	POLE
	POWER POLE



DATE CREATED:	7/14/22
DATE REVISED:	
DRAWN BY:	RAMTeCH

SCALE: 1:50

COMPANY:	Windstream
SYSTEM:	ASHLAND, NE
PROJECT NUMBER:	715022049
DESCRIPTION:	FTTP GPON PERMIT
MAP:	

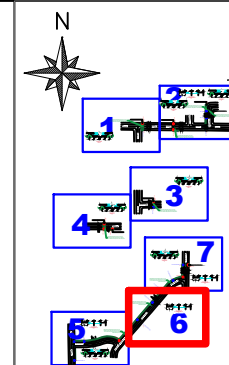
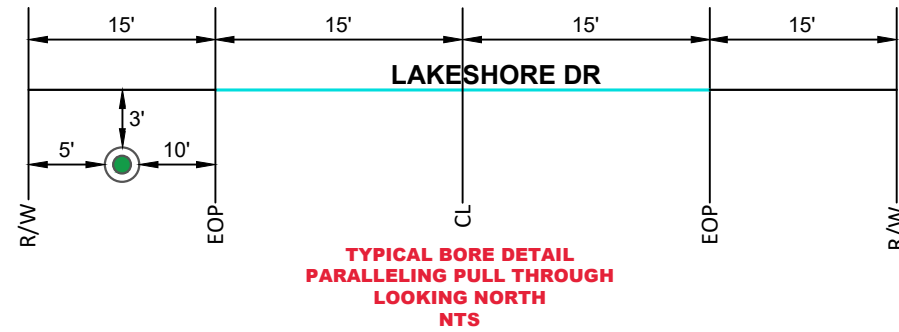

### LEGEND

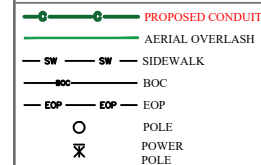

DATE CREATED: 7/14/22

DATE REVISED:

DRAWN BY: RAMTeCH

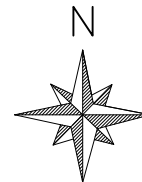

SCALE: 1:50

COMPANY:

Windstream

SYSTEM:  
ASHLAND, NE

PROJECT NUMBER:  
715022049

DESCRIPTION:  
FTTP GPON PERMIT

MAP:

6 OF 7

RAMTeCH

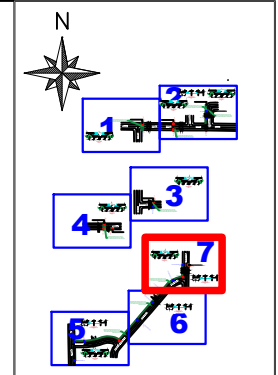

LEGEND

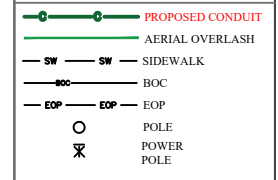

DATE CREATED: 7/14/22  
DATE REVISED:  
DRAWN BY: RAMTeCH

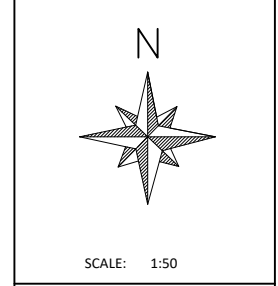

COMPANY:  
Windstream  
SYSTEM:  
ASHLAND, NE  
PROJECT NUMBER:  
715022049  
DESCRIPTION:  
FTTP GPON PERMIT  
MAP:

7 OF 7

RAMTeCH

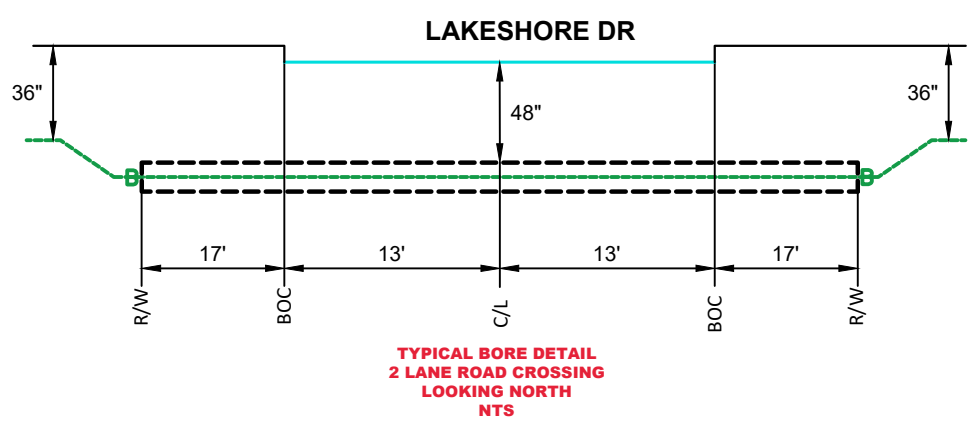

DIRECTIONAL BORE AND PLACE 1704' OF 1(1.25)" INNERDUCT WITH 48CT FIBER CABLE AT A DEPTH OF 36" FROM PED PINE RIDGE RD/151NI TO PED LAKESHORE DR/1210C.

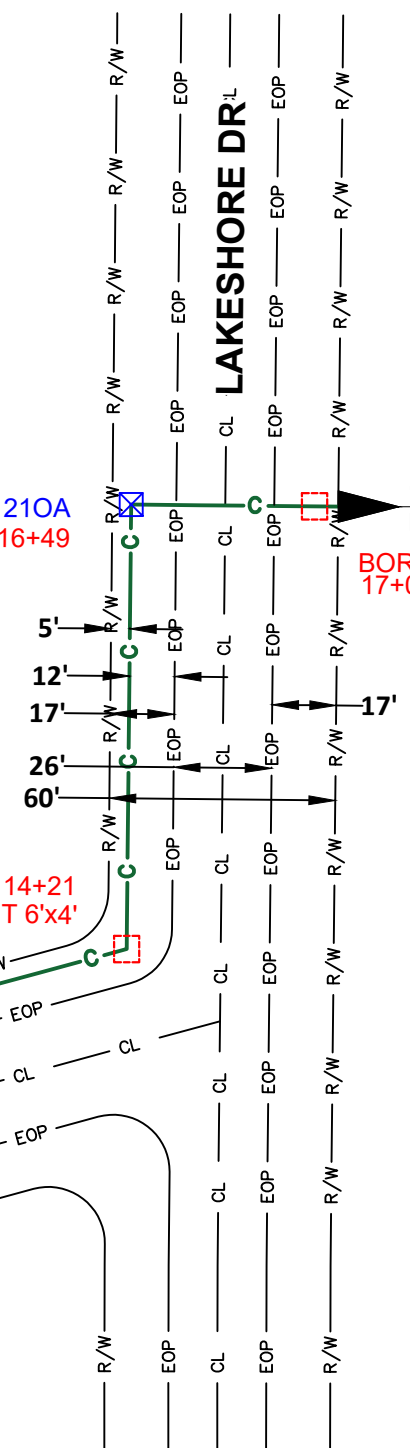
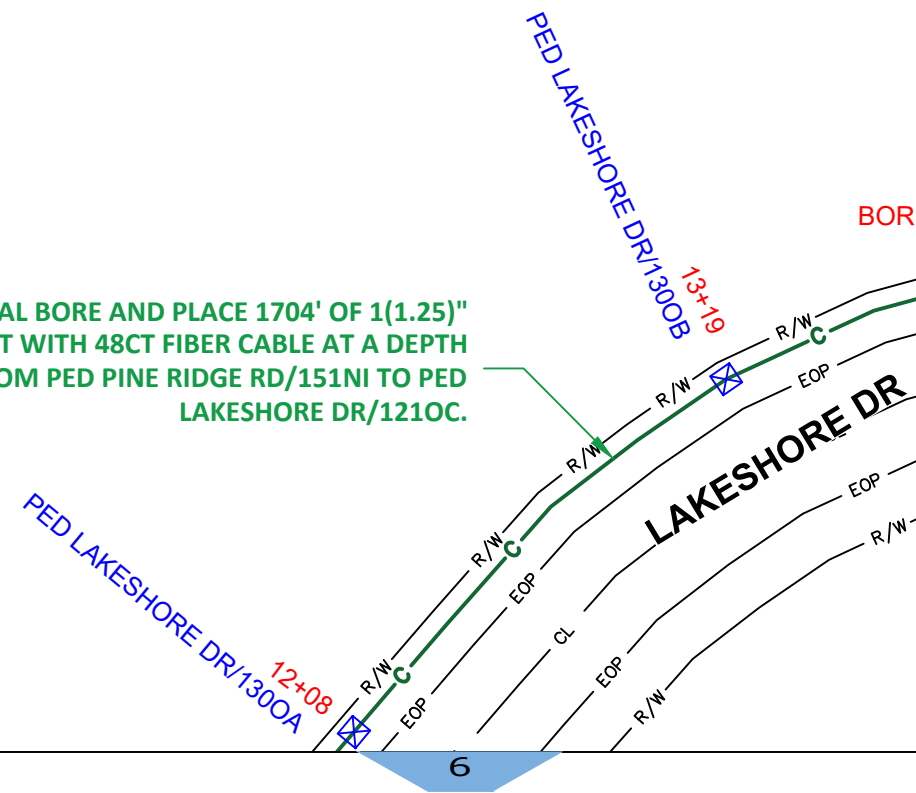

CONTINUE FROM EXISTING PED LAKESHORE DR/1210C PRIVATE PROPERTY  
BORE PIT 6'x4' 17+04

