

Notes:

1. This play structure design will meet ADA Accessibility Guidelines for Buildings and Facilities, effective March 15, 2012 as published by the Architectural and Transportation Barriers Compliance Board with the addition of 0, ground level play components of 0 different types of play and when installed over accessible surfacing.
2. This site plan should be checked against the actual site area prior to the purchase or installation of equipment.
3. The unit of measure located in the center of the platform indicates the height above the protective surfacing level. The protective surfacing for this design must accommodate a fall height of at least 7' unless otherwise noted.
4. The structure size for this unit is 48 x 37, requiring protective surfacing for an overall use zone of 60 x 49. The approximate surface area is 1784 sq. ft. by ASTM F 1487-07 guidelines.
5. The structure is designed to accommodate 118 children from 2-5 years of age.
6. Supervise Children as they play.
7. To Ensure that accurate measurements are obtained from this site plan, print copies on 11 x 17 paper at full scale.
8. The customers responsibility is to check local soil conditions and drainage within the site. The site must also be surveyed for underground utilities prior to excavation.
9. Completely read your installation manual prior to beginning construction.
10. This design configuration is the property of this firm and Playland Inc. and may not be reproduced or used in any manner without the expressed written consent of this firm and Playland
11. Perimeter Requires 46 Land Scape Timbers 4' Long.

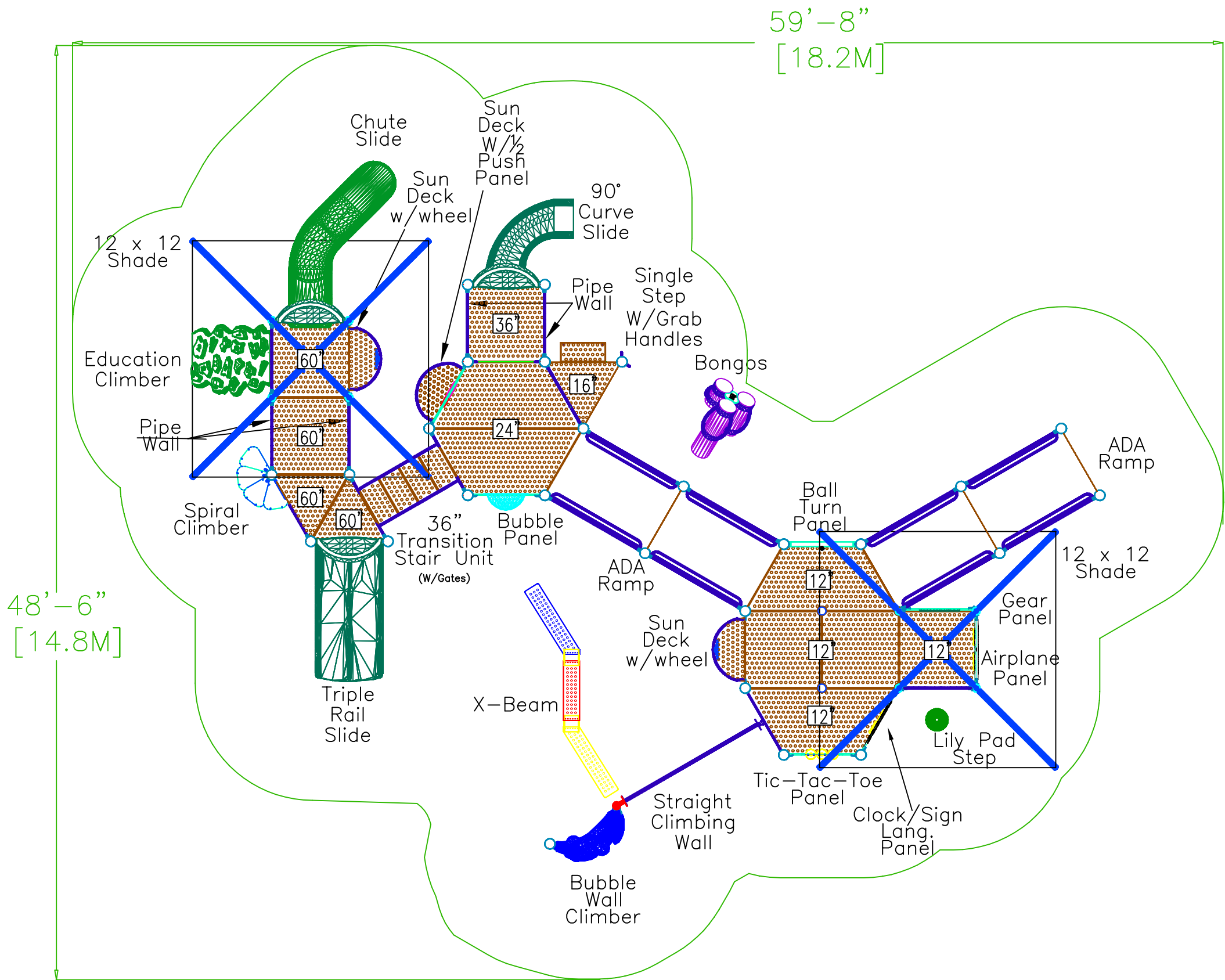



PS5-31920

STRUCTURE **PS5-31920**

For illustration purposes only. Colors may vary.

Playgrounds

BY SUPERIOR RECREATIONAL PRODUCTS

• GENERAL PRODUCT • Specifications



General Product Specifications

At Superior Playgrounds, we only use quality playground materials — whether purchasing a steel or recycled structure. Manufactured at our west Georgia manufacturing facility, our playgrounds are proudly made in the USA. You can trust our playgrounds are built to last and will provide fun for years to come.

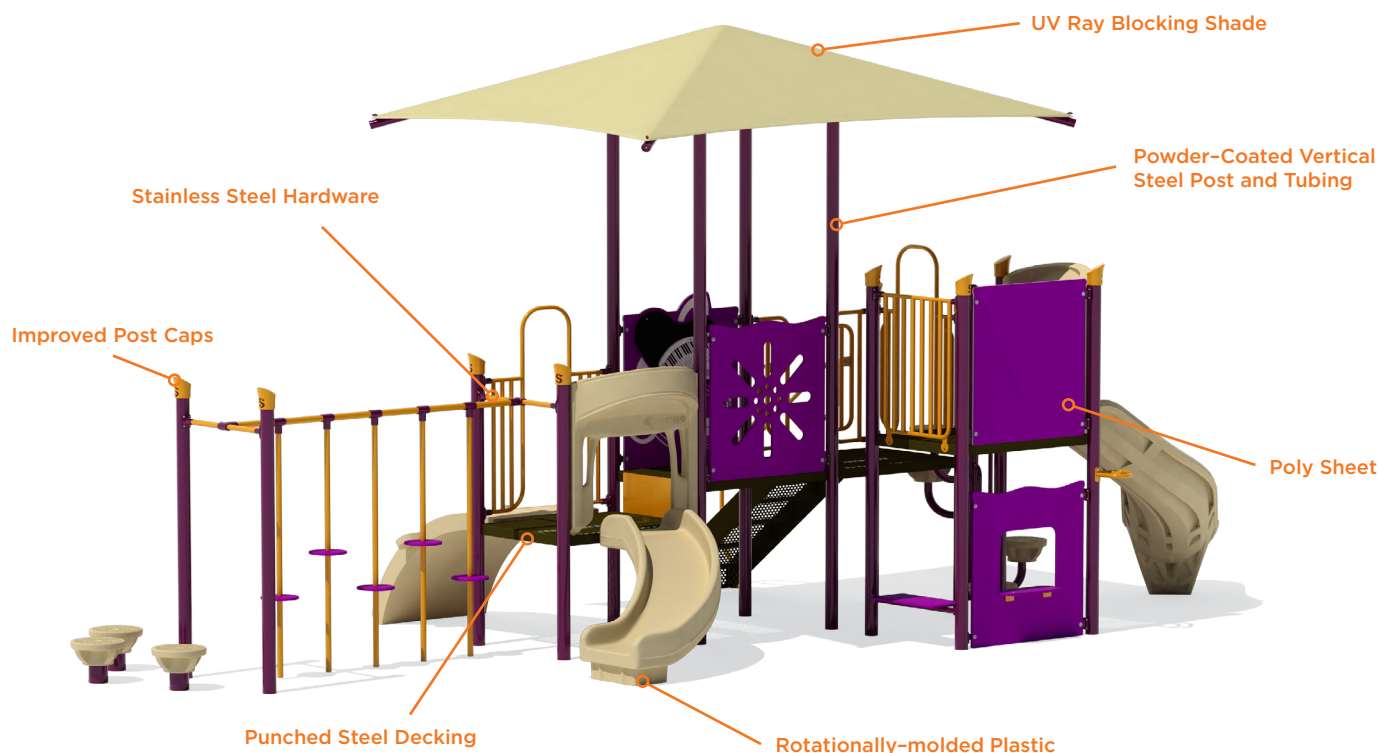

3.5" Commercial Playground Series

- 3.5" O.D. vertical posts
- 36" deck grid / 46.5" deck grid
- 24" diameter plastic / 30" diameter plastic

5" Commercial Playground Series

- 5" O.D. vertical posts
- 48" deck grid
- 30" diameter plastic

Vertical Posts (Round Steel Tubing)

- 13 gauge galvanized steel (3.5" Series)
- 11 gauge galvanized steel (5" Series)
- 11 gauge galvanized steel (shade verticals)
- 50,000 PSI yield strength (ASTM E-8)
- 55,000 PSI tensile strength (ASTM E-8)
- Triple Flo-Coated corrosion protection – interior and exterior (ASTM B-117)
- Contains a minimum of 30% recycled steel and is 95%-98% recyclable
- Manufactured per ASTM A570

Vertical Posts (R3 Recycled Plastic)

- 6"x6" posts made of HDPE
- Molded in one piece
- UV additives to prevent deterioration from UV light
- Made of 100% recycled material (post-industrial and post-consumer) excluding additives and colorants
- Will not rot, split, crack or splinter for a minimum of 50 years
- Resistant to termites, marine borers, salt spray, oil and fungus



Tubing

- Contains a minimum of 30% recycled steel and is 95%-98% recyclable
- Triple Flo-Coated corrosion protection (interior and exterior)
- Interior and exterior corrosion resistance (ASTM B-117)
- Manufactured per ASTM A570
- 50,000 PSI yield strength (ASTM E-8)
- 55,000 PSI tensile strength (ASTM E-8)

1.25" O.D. Round	14 gauge galvanized steel
1.66" O.D. Round	13 gauge galvanized steel
1.90" O.D. Round	11 gauge galvanized steel
2.375" O.D. Round	3 gauge galvanized steel / 9 gauge steel (Bi-pod/Tri-pod top bar/ Superior Shape frame)
3.5" O.D. Round	13 gauge galvanized steel (3.5" Series)
4" O.D. Square	11 gauge galvanized steel
5" O.D. Round	11 gauge galvanized steel (5" Series)



POST CAPS

- Aluminum alloy (ZL101) aluminum series of tertiary alloys
- Tested using GB/T 1173-1995 (equivalent to ANSI 365.0 specified in ASTM B26/B26M)
- Less than 40ppm of lead per IEC 62321:2008 Ed. 1 and US EPA 3050B: 1996
- Powder coat finish

C-LINE FITTINGS

- Aluminum alloy (ZL101, GB/T 1173-1995) aluminum series of tertiary alloys
- Less than 40ppm of lead per IEC 62321:2008 Ed. 1 and US EPA 3050B: 1996
- Mounts to vertical post with gasket and four 0.25"x1" self-tapping screws with patch
- Powder coat finish

SEALING GASKET

- Neoprene rubber
- 60 +/- 5 durometer hardness



HARDWARE

- Made from stainless steel or corrosion-resistant coated steel
- Conforms to ANSI/ASCE-8-90 (stainless steel)
- Passed 100 hour salt test (corrosion-resistant coated steel)
- Security patch to insure screw locks into vertical pipe (where applicable)
- Most hardware is tamper resistant

R3 RECYCLED PLASTIC COMPONENTS

- Made of HDPE
- Molded in one piece
- UV additives to prevent deterioration from UV light
- Made of 100% recycled material (post-industrial and post-consumer) excluding additives and colorants
- Will not rot, split, crack or splinter for a minimum of 25 years
- Resistant to termites, marine borers, salt spray, oil and fungus



Roto-molded Plastics

- 1st quality linear low density Polyethylene (LDPE)
- Rotational molded with mold-in graphics (where applicable)
- 0.375" wall thickness
- 2,550 psi tensile strength (ASTM D638)
- Melt index per ASTM D1238
- Density per ASTM D4883
- Peak crystallization temperature per ASTM D3418
- Flexural modulus per ASTM D790 Procedure B
- Deflection temperature under load per ASTM D648
- Environmental stress crack resistance, F50 per ASTM D1693 Condition A
- UV stabilized / UV 8 Rating (tested per ASTM G155 cycle 1 guidelines)
- Anti-static inhibitors



Poly Sheet

- 0.75" high density polyethylene sheeting (HDPE)
- Tested in accordance with ASTM D1928 Procedure C
- Density per ASTM D1505
- Melt Index per ASTM D1238
- Tensile Strength and Ultimate Elongation per ASTM D638 Type 4
- Brittleness temperature per ASTM D746
- Flexural modulus per ASTM D790
- Coefficient of linear thermal expansion per ASTM E831
- Textured, matte finish
- UV stabilized
- UL 94 HB fire rating
- Stain and graffiti resistant and will not delaminate, splinter or crack

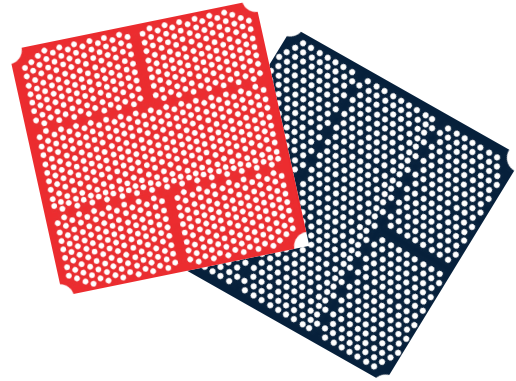

Punched Steel Items

Decks, Platforms, Ramps, Bridges, Transfer Stations, Stairs, and Steps

- 12 gauge galvanized steel body
- Formed sides with welded reinforcements (stairs have welded stringers)
- 0.625"x1" diameter slots after coating
- Decks for recycled structures have a plank pattern 5.625" wide with 0.3125" spacing after coating
- Platisol coating
- Lead-free per 16 CFR Part 1303

Powder Coat

- Initially blasted to a 'white' condition to remove all surface rust and oil, our steel frames are coated electrostatically with an Epoxy TGIC Powder Coating Zinc-Rich Primer. Superior's primer has been tested salt spray tested for over 4,000 hours to insure quality. After the primer application, Superior applies the Super durable Polyester TGIC powder coating electrostatically. After the application of the final coat, a total of 6 mils of finished Powder Coating has been applied, which is backed by 5,000 hours of testing (ASTM Method B117).
- The Limited Warranty for Powder Coating provides for the following after a five year exposure period when applied according to the recommendations listed on the product's technical data sheet and appropriate surface preparation has been utilized.
- The coatings shall retain their original color with a ΔE of < 7.5 units for high chroma colors, (yellows, reds, oranges, etc.) and a ΔE of < 5.0 units for low chroma colors, when tested in accordance with ASTM D 2244.
- The coating shall retain a minimum of 50% of its original gloss level after washing, when tested in accordance with ASTM D 523.
- The coating shall exhibit chalking no worse than a numerical rating of 6, when evaluated in accordance with ASTM D 659-80.

Standard Color Options

Rotationally Molded Colors



HDPE Panels Available in 1- and 2-color

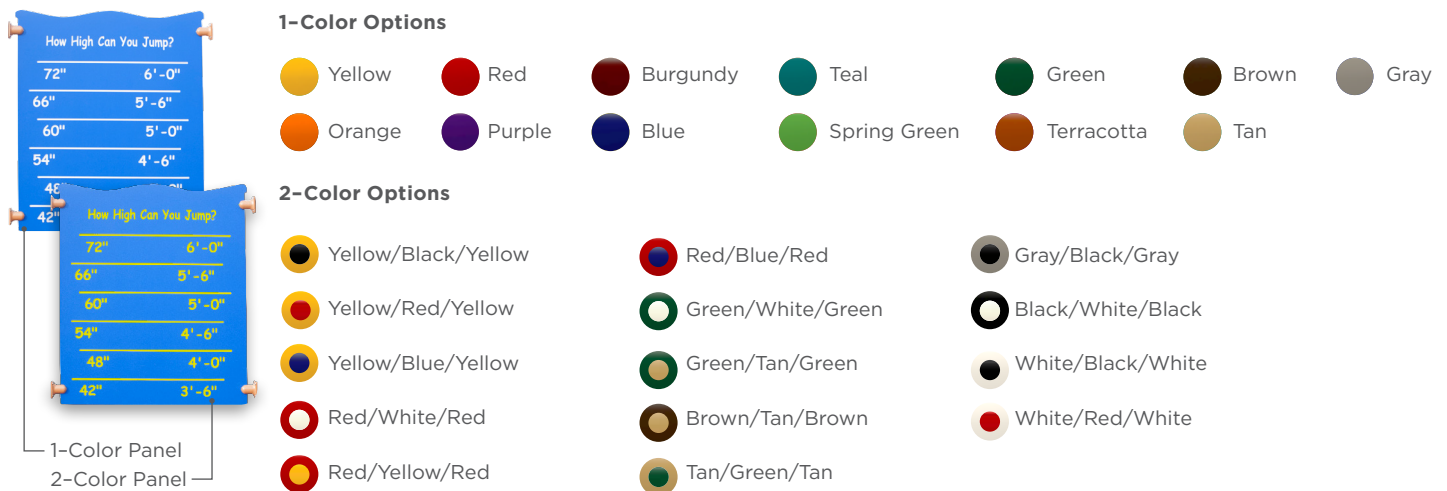

Powder Coat Colors



Shade Colors | More colors available!

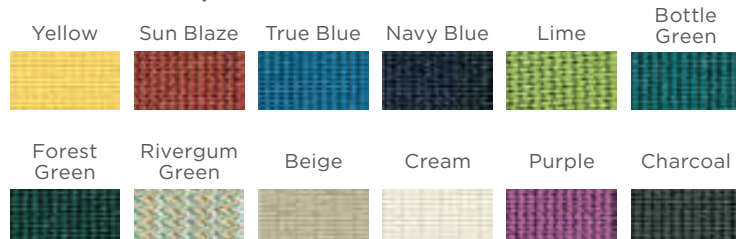

Recycled Decks & Posts

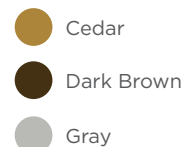

Decks, Bridges, and Stairs

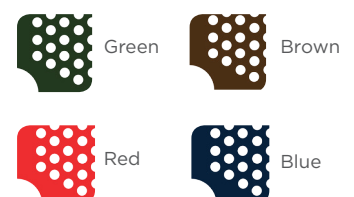

All fabric is California Fire Marshal certified (highest standard for flame resistance), with the exception of Rivergum Green. More colors are available.

Popular Color Schemes



Rain Forest

- Sky Blue
- Green
- Spring Green
- Royal Blue



Circus

- Red
- Yellow
- Royal Blue



Fresco

- Gray
- Teal



Midnight Jazz

- Mariner Blue
- Red
- Gray
- Black



Autumn

- Red
- Tan
- Orange



Robin Egg

- Brown
- Tan
- Teal



Adventure

- Gray
- White
- Red



Nature Trail

- Terracotta
- Tan
- Spring Green
- Orange



Forest

- Burgundy
- Tan
- Green



Aquamarine

- Teal
- White
- Mariner Blue
- Brown



Plum

- Purple
- Butterscotch
- Tan



Fortress

- Cobalt
- Butterscotch
- Tan
- Terracotta

Quality, Standards And Guidelines



American Society for Testing and Materials

The American Society for Testing and Materials is an independent and world renowned developer of technical standards utilized in testing a multitude of products. ASTM's F15.29 committee, met consistently for over a decade in the continual development of the F1487 Standard Consumer Safety Performance Specifications for Playground Equipment for Public Use. The current version is F1487-11, published in 2011.



Access Board (ADAAG)

Guidance Available on Play Area Guidelines: <http://www.access-board.gov/news/playguide.htm>

Access Board (The United States Architectural and Transportation Barriers Compliance Board) has completed Accessibility Guidelines for Play Facilities as set forth in the Americans with Disabilities Act of 1990. The Final Report of the Regulatory Negotiation Committee is available via the Internet.



IPEMA™

In the interest of playground safety, the International Play Equipment Manufacturers Association (IPEMA) provides a Third Party Certification Service whereby a designated independent laboratory, TÜV SÜD America Inc., (TÜV), validates an equipment manufacturer's certification of conformance to the ASTM F1487 Standard Consumer Safety Performance Specification for Playground Equipment for Public Use, except sections 7.1.1, 10 & 12.6.1; to CAN/CSA Z614 Children's Playspaces and Equipment, except clauses 9.8, 10 and 11; or both. A list of current validated products may be viewed at www.ipema.org.



U.S. Consumer Safety Product Commission

Handbook for Public Playground Safety: <http://www.cpsc.gov/cpscpub/pubs/325.pdf>

Superior Warranty

Our warranty guarantees years of unlimited fun!

- **Lifetime*** warranty on steel posts, all stainless steel hardware, component clamps and aluminum post caps
- **25 Year** Limited warranty on recycled posts
- **15 Year** Limited warranty on pipes, rungs, loops and rails, roto-molded plastics, HDPE plastic sheets, punched steel decks
- **10 Year** Limited warranty on Shade fabric
- **5 Year** Limited warranty on Site Amenities, cables and nets
- **3 Year** Limited warranty on "The Original KidsCenter™"
- **1 Year** Limited warranty on moving parts, materials not covered above & water slides

* For the purpose of this warranty, lifetime encompasses no specific term of years, but rather that seller warrants to its original customer for as long as the original customer owns the product and uses the product for its intended purpose that the product and all parts will be free from defects in materials and manufacturing workmanship. This warranty does not cover damage caused by vandalism, misuse or abuse, altered or modified parts, or cosmetic damage such as scratches, dents, or fading or weathering and normal wear and tear. This warranty is valid only if the structures are installed in conformity with instructions provided by Superior Recreational Products using approved Superior Recreational Products parts. Superior Recreational Products will deliver the repaired or replacement part or parts to the site free of charge, but will not be responsible for labor or the labor costs of replacement. Warranty claims must be filed within the applicable warranty period and accompanied by a sales order or invoice number.