

ARCHITECT  
★  
MICHAEL D.  
FAKLER  
A-3413  
STATE OF NEBRASKA  
4/15/2024

THIS RECORD COPY OF THIS DRAWING  
IS TO BE KEPT ON FILE AT THE OFFICE OF FAKLER  
ARCHITECTS, L.L.C. 1001 N. 6TH ST.  
LINCOLN, NEBRASKA 68310. THIS  
DRAWING IS RELEASED FOR THE PURPOSES OF  
REGULATORY APPROVAL, PERMITTING, AND  
CONSTRUCTION UNDER THE AUTHORITY  
OF MICHAEL D. FAKLER, NEBRASKA  
REGISTERED PROFESSIONAL ARCHITECT,  
REGISTRATION # A-3413, ON APRIL 15,  
2014. ANY MODIFICATION(S) TO THIS DRAW-  
ING SHALL BE IN COMPLIANCE WITH THE  
NEBRASKA BOARD OF ENGINEERS AND ARCHITECTS RULES.

PH 402-228-3020 FAX 402-228-3018  
E-MAIL michael@faklerarchitects.com

PROJECT #1455

ARCHITECT  
★  
MICHAEL D.  
FAKLER  
A-3413  
STATE OF NEBRASKA  
4/15/2024

THIS RECORD COPY OF THIS DRAWING  
ON FILE AT THE OFFICE OF FAKLER  
ARCHITECTS, L.L.C. 1001 N. 6TH ST.  
LINCOLN, NEBRASKA 68310. THIS  
DOCUMENT IS RELEASED FOR THE PURPOSES OF  
LEGISLATIVE APPROVAL, PERMITTING, AND  
CONSTRUCTION UNDER THE AUTHORITY  
OF MICHAEL D. FAKLER, NEBRASKA  
REGISTERED PROFESSIONAL ARCHITECT, REGISTRATION # A-3413, ON APRIL 15,  
2014. ANY MODIFICATION(S) TO THIS DRAW-  
ING SHALL BE IN COMPLIANCE WITH THE  
NEBRASKA BOARD OF ENGINEERS AND ARCHITECTS RULES.

PH 402-228-3020 FAX 402-228-3018  
E-MAIL michael@faklerarchitects.com

1103 Main St., Crete, Nebraska 68003

Official

CONST. ISSUE

**A-2**  
PROJECT #1455

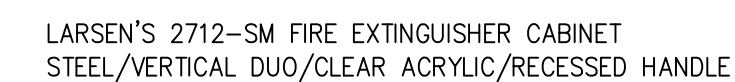



FIELD VERIFY  
ALL EXISTING DIMENSIONS

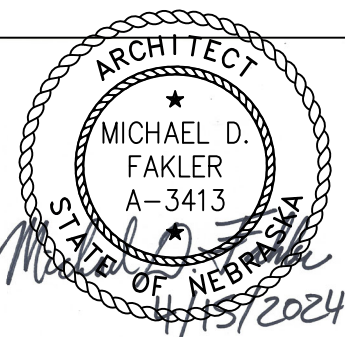

I, MICHAEL D. FAKLER, AM THE COORDINATING PROFESSIONAL ON THE OLD MAIN BAR & GRILL PROJECT

THE RECORD COPY OF THIS DRAWING IS ON FILE AT THE OFFICE OF FAKLER ARCHITECTS, L.L.C. 1001 N. 6TH ST. BEATRICE, NEBRASKA 68310. THIS DOCUMENT IS RELEASED FOR THE PURPOSES OF REGULATORY APPROVAL, PERMITTING, AND CONSTRUCTION UNDER THE AUTHORITY OF MICHAEL D. FAKLER, NEBRASKA REGISTRATION # A-3413, ON APRIL 15, 2024. ANY MODIFICATIONS TO THIS DRAWING SHALL BE IN COMPLIANCE WITH THE NEBRASKA BOARD OF ENGINEERS AND ARCHITECTS RULES.

**FAKLER ARCHITECTS, L.L.C.**  
1001 N. 6th ST., BEATRICE, NE 68310  
PH 402-228-3020 FAX 402-228-3018  
E-MAIL michael@faklerarchitects.com

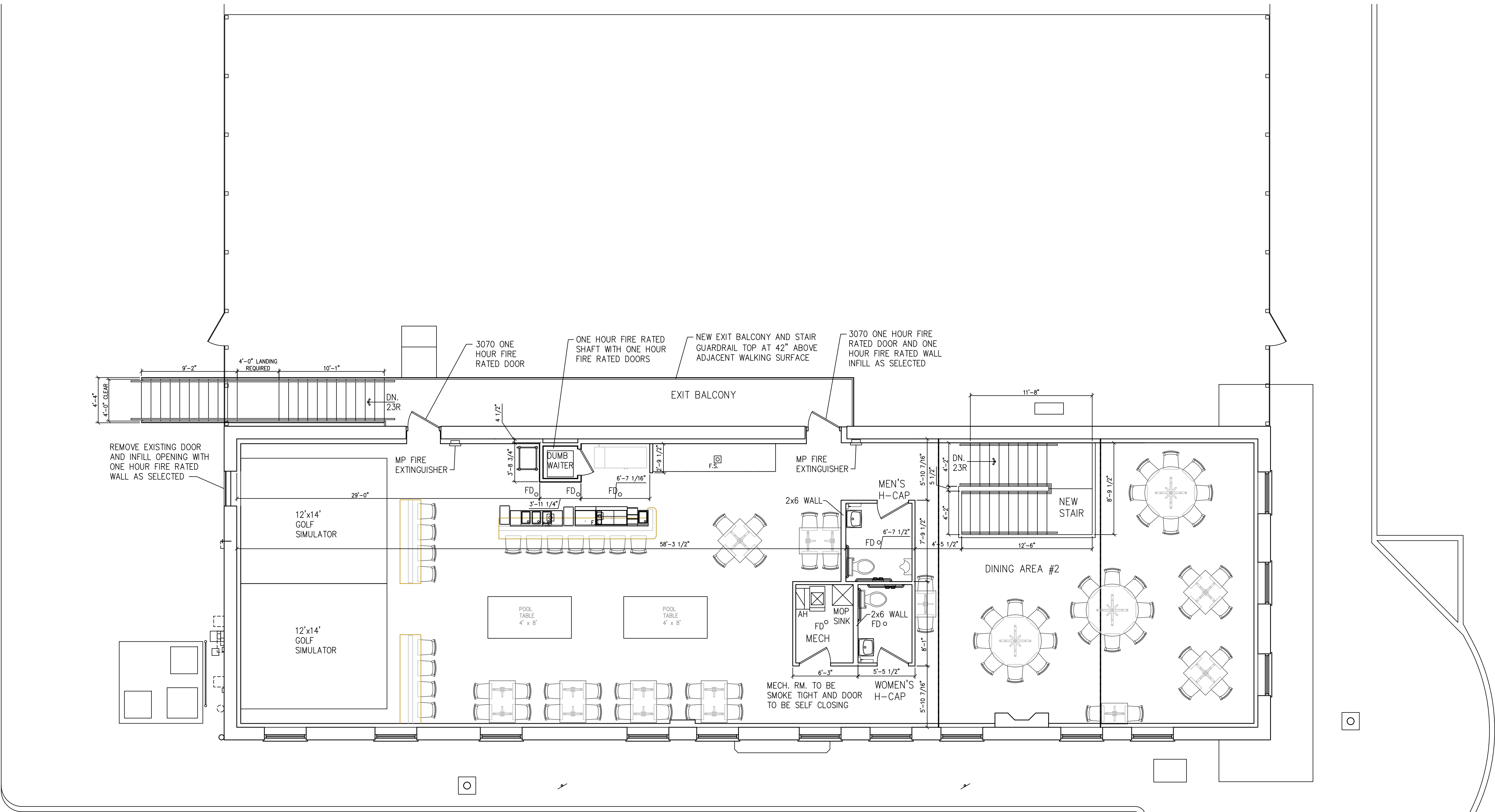

NEW SECOND FLOOR PLAN  
SCALE: 3/16" = 1'-0"

NOTE:  
ALL FIRE RATED OPENINGS (INCLUDING DUMB WAITER SHAFT OPENINGS) ARE TO BE SELF CLOSING AND SELF LATCHING. PROVIDE PANIC HARDWARE ON ALL EXIT & EXIT ACCESS DOORS.

NOTE:  
ALL NEW STAIRS 7" MAX RISER, 11" TREAD, HANDRAILS ON EACH SIDE OF STAIR, TOP OF HANDRAIL 34" ABOVE STAIR NOSINGS

NOTE:  
SEE OWNER'S STRUCTURAL DRAWINGS FOR ALL STRUCTURAL INFORMATION AND REQUIREMENTS.



MP FIRE EXTINGUISHER:  
LARSEN'S MP10 - 10 POUND MULTI-PURPOSE DRY CHEMICAL EXTINGUISHER  
LARSEN'S 2409-6R OR 2409-SM FIRE EXTINGUISHER CABINET AS REQUIRED BY LOCATION  
STEEL/VERTICAL DUO/CLEAR ACRYLIC/RECESSED HANDLE

WC FIRE EXTINGUISHER:  
LARSEN'S WC-6L - 6 LITER WET CHEMICAL EXTINGUISHER

LARSEN'S 2712-SM FIRE EXTINGUISHER CABINET  
STEEL/VERTICAL DUO/CLEAR ACRYLIC/RECESSED HANDLE

NEW SECOND FLOOR PLAN

REVISIONS
PRELIMINARY ISSUE 8/23/2023
BID ISSUE
PERMIT ISSUE 4/15/2024
CONST. ISSUE

**A-3**  
PROJECT #1455

Old Main Bar & Grill

1103 Main St., Crete, Nebraska 68333