

**Madison Board of Education, Madison District #1**

Special Meeting: Board Work Session  
Thursday, October 1, 2020 6:30 PM  
Conference Room, Madison Middle/High School  
700 South Kent St.  
Madison, NE 68748-0450

*The sequence of items on the agenda is provided as a courtesy. The board reserves the right to consider items in any sequence deemed appropriate. Therefore, visitors are encouraged to attend the meeting from the beginning.*

1. Call Meeting to Order
  1. Roll Call/Excuse absent Board members
  2. Pledge of Allegiance
  3. Declare the meeting to be open, legal, and properly advertised
2. Accept the agenda as the official agenda
3. Break for Supper
4. Discussion on options to address bleacher usage in the new gym.
5. Watch video of NASB Regional meeting.
6. Adjournment

*The board reserves the right to enter executive session if it deems it necessary to prevent needless injury to a staff member's reputation or for the protection of the public interest.*

# Madison Public Schools

**Alan Ehlers**  
Superintendent

**Jim Crilly**  
HS Principal  
**Reid Ehrisman**  
MS Principal/EL

**Karla Kush**  
Elementary Principal

700 So Kent St.  
P.O. Box 450  
Madison, NE 68748  
District Phone (402) 454-3336 Fax (402) 454-2238  
Elementary Phone (402) 454-2656 Fax (402) 454-3978

**Travis Jordan**  
Director of CAI  
**Crystal Ernst**  
Instructional Coach  
**Landonn Mackey**  
Athletic Director  
**Celine Filsinger**  
Office Manager

**The mission of Madison Public Schools is to prepare students to be competent, confident, productive, and responsible citizens.**

## New Gym bleacher options for discussion 10-1-2020

**Option #1** southeast corner – Build a ladder for the video mezzanine estimated cost \$1580.00

Build a platform and rail for the northeast corner with an estimated cost of \$942.00

Total cost \$2,522.00 split 3 ways (Michael, DWB & MPS) = \$840.66 each

Sheridan Bleachers supplies 4 curtains as a cost of \$2275.00 and DWB installs at n/c to the District.

**Option #2** Build a non-code permanent stairs on each side with an estimated cost of \$20,000+

Sheridan supplies two curtains for the west side of each bleacher and pays \$1137.00 toward the steps.

The cost would be too high and the steps would not be legal. If forced to remove at a later time would damage the wood floor would cost more.

Notes:

Reasons to not move the bleachers over:

- The aisles were designed to match the location of the gym windows.
- A smaller gap would still remain between the bleachers and the walls.
- Estimated labor cost would be over the \$10,000.
- Good chance it would cause more damage to the floor.



Option # 1

\$ 1,580.00

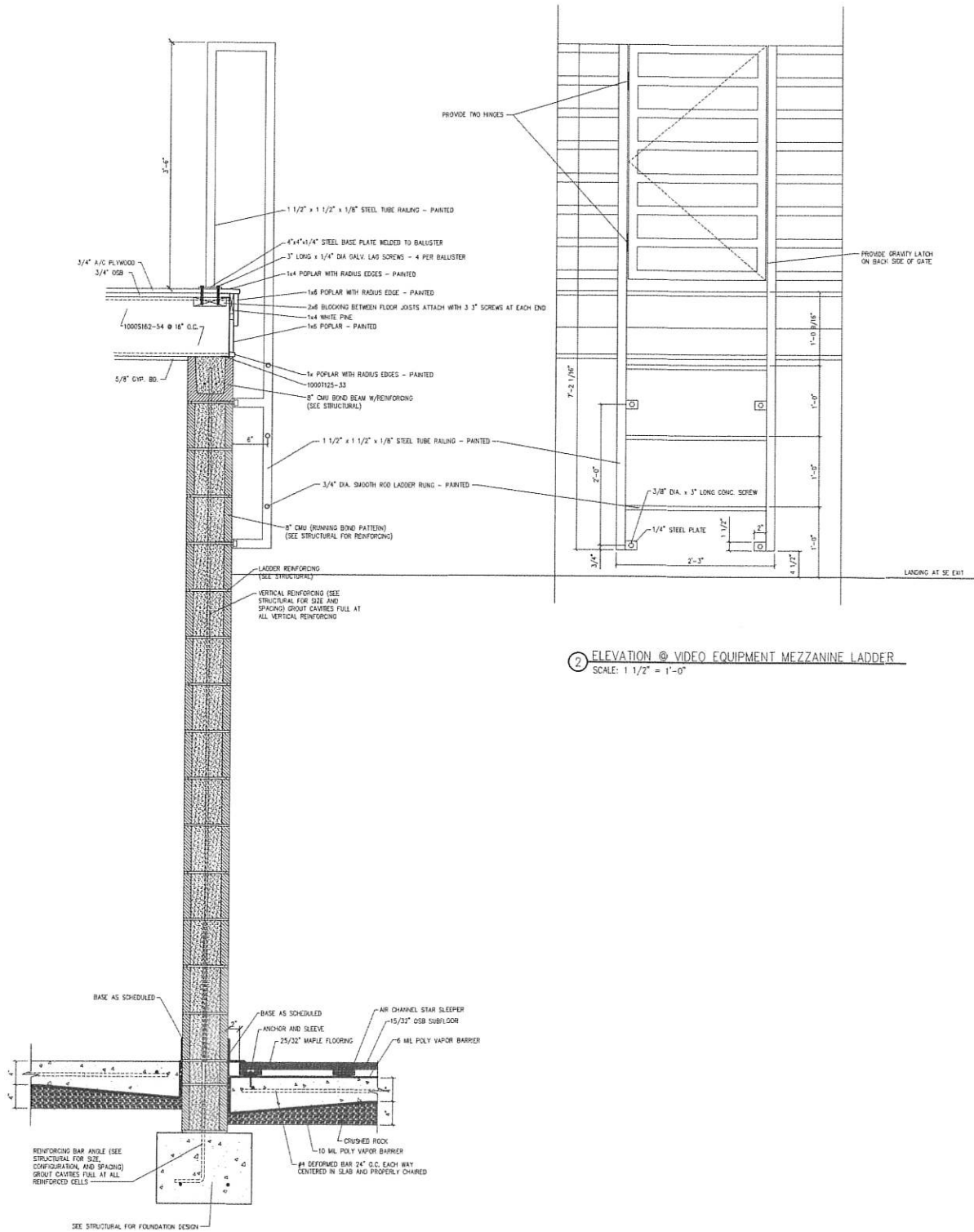

② ELEVATION @ VIDEO EQUIPMENT MEZZANINE LADDER  
SCALE: 1 1/2" = 1'-0"

① SECTION @ VIDEO EQUIPMENT MEZZANINE LADDER  
SCALE: 1 1/2" = 1'-0"

